



Q&A

Alan German & Chris Taylor
Ottawa PC Users' Group

Share

SmartApps

- Useful apps for Android smartphones and tablets
- What are your favourites?



SuggestionBox@opcug.ca

Share

SmartApps

- Useful apps for Android smartphones and tablets
- What are your favourites?



SuggestionBox@opcug.ca

Could also be your favourite PC app!



Changing Icons on an Android Smartphone

*Alan German
Ottawa PC Users' Group*

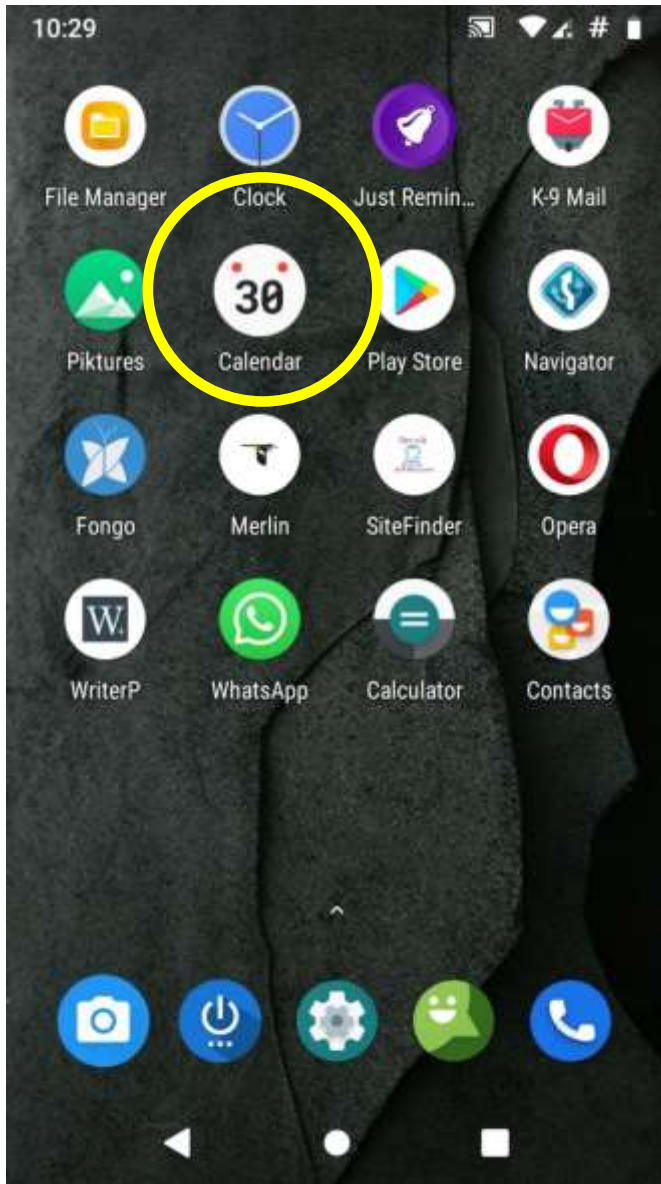

“Ugly” icon for the calendar app

Replace it with the icon used on the Google’s Pixel phone





Awesome icons

Momo apps Personalisation

★★★★★ 9,208 

E Everyone

Offers in-app purchases

 Add to wishlist

Install



Simo Tukiainen CO-FOUNDER

Software architect, development mentor, adept programmer



Henri Tukiainen CO-FOUNDER

Project leader, full stack developer, agile software development expert

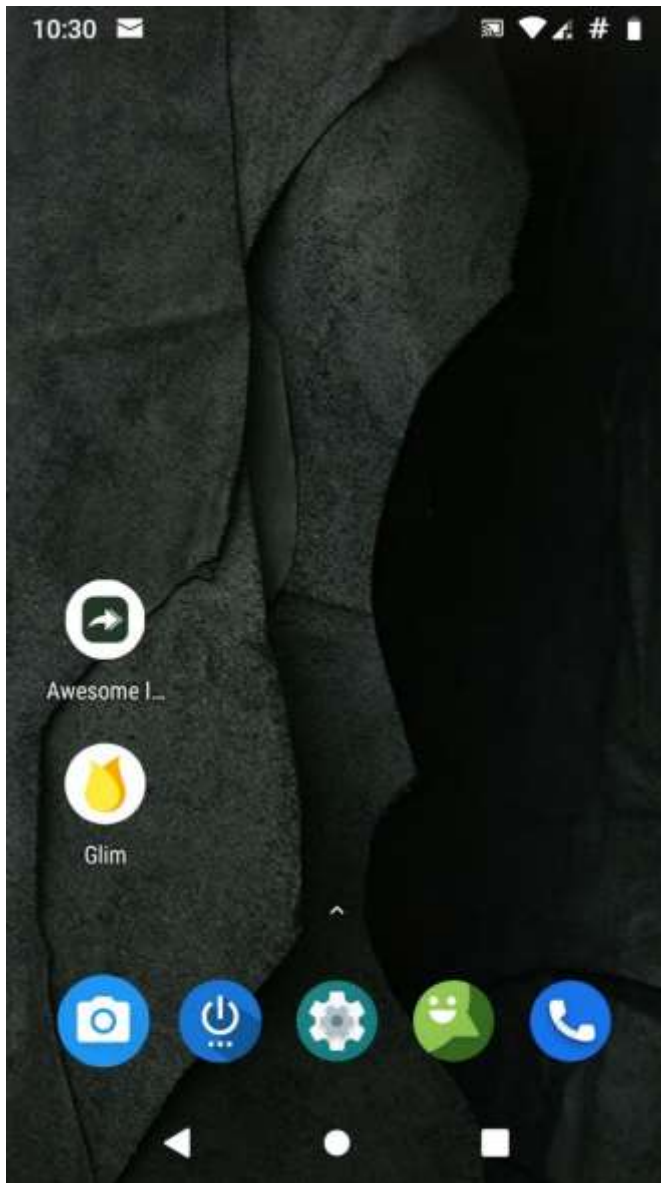

Installed:

Awesome Icons



Glim – Icon Pack



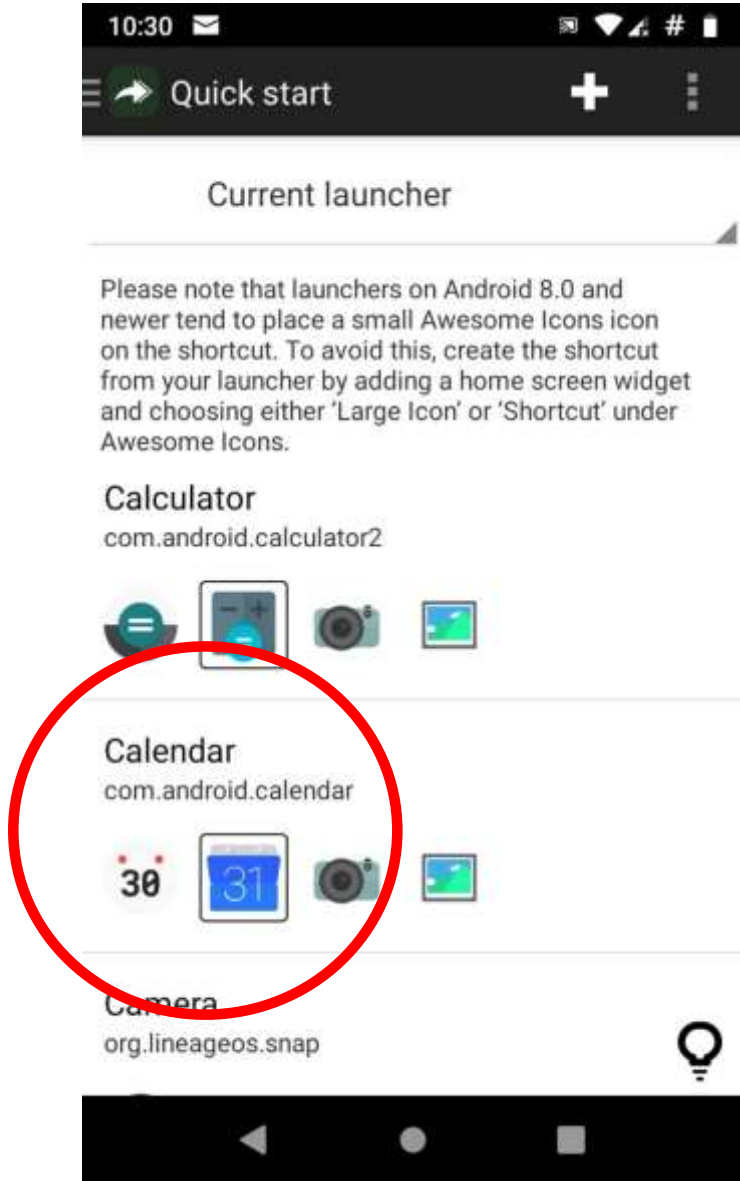

Run Awesome Icons

We want to modify
the icon for the
calendar app

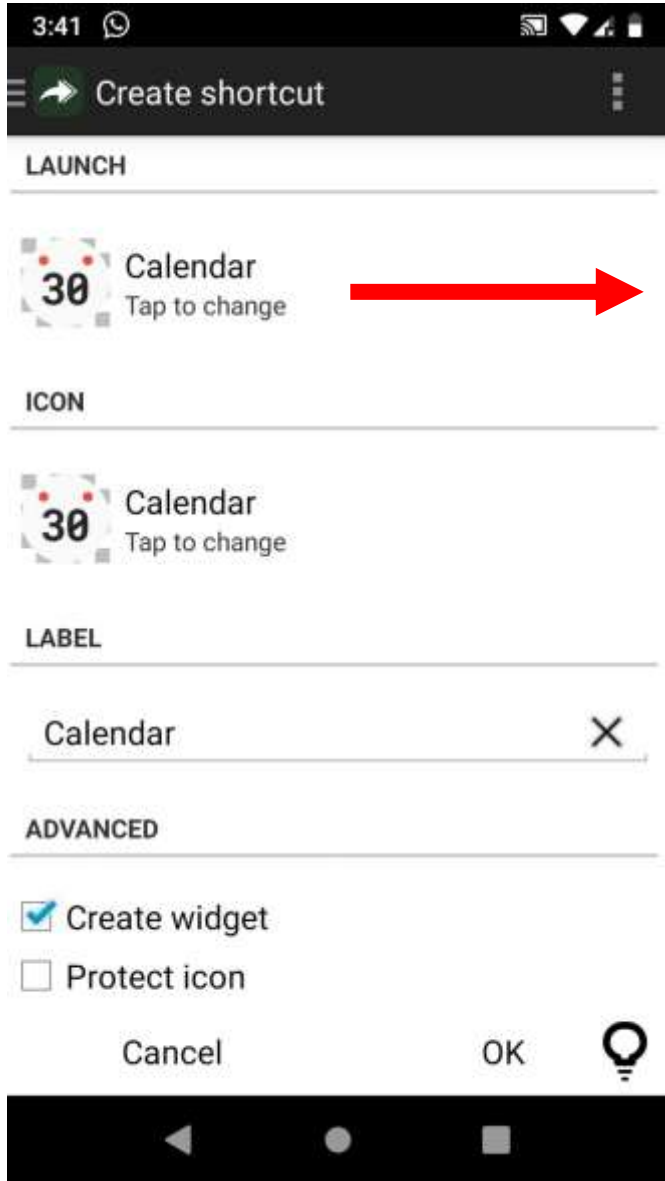

Icon to be changed

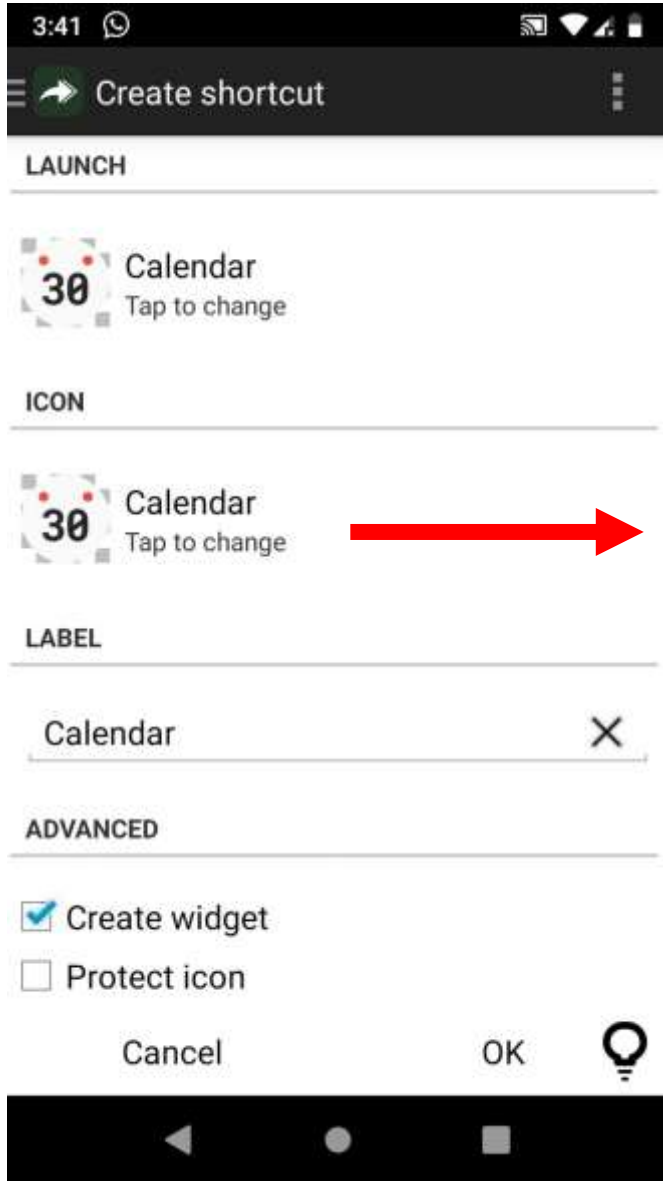

Select image source

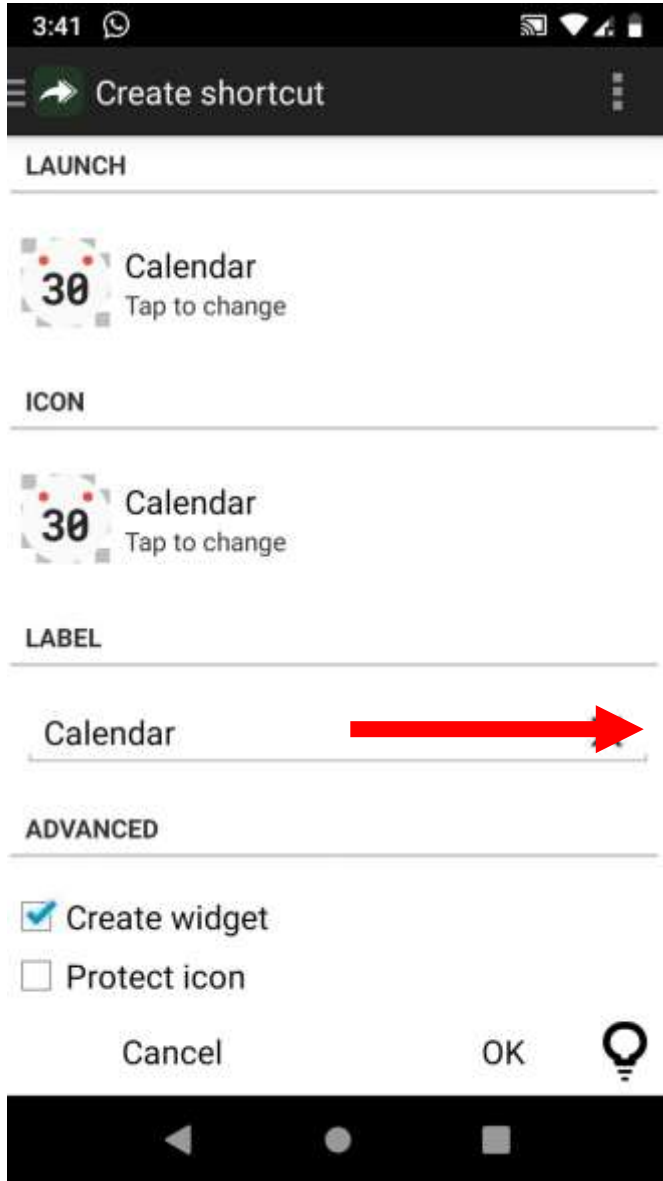

Edit caption

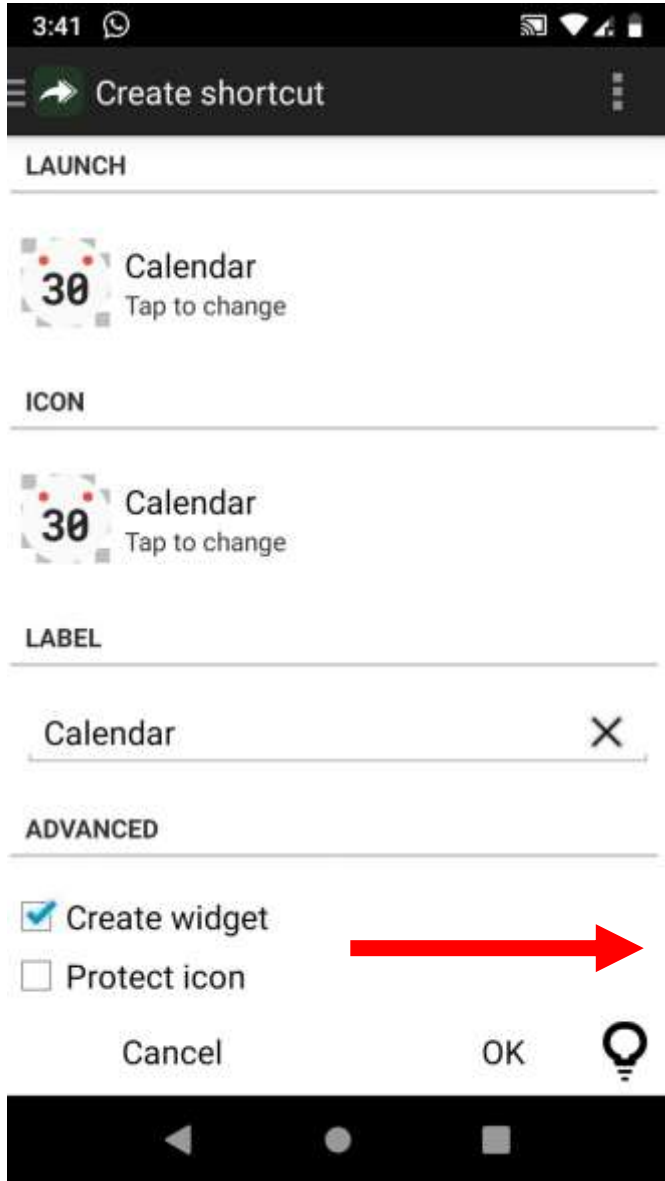

Controls

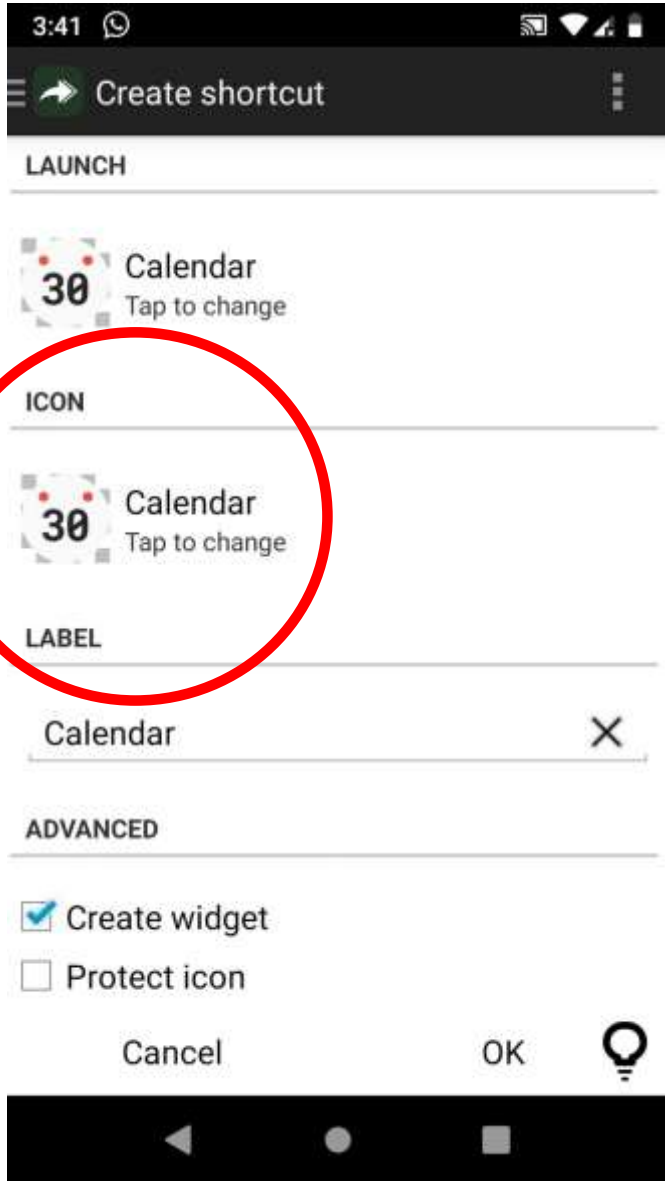

Tap to select
image source

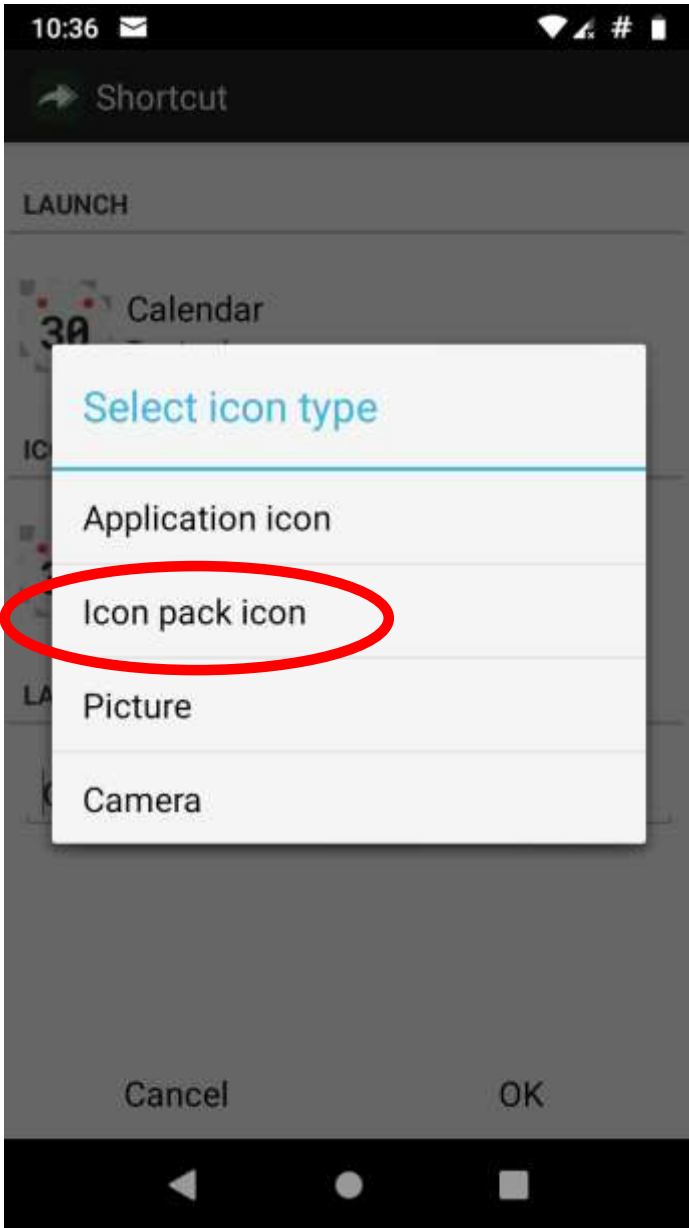

We have the Glim
icon pack already
downloaded



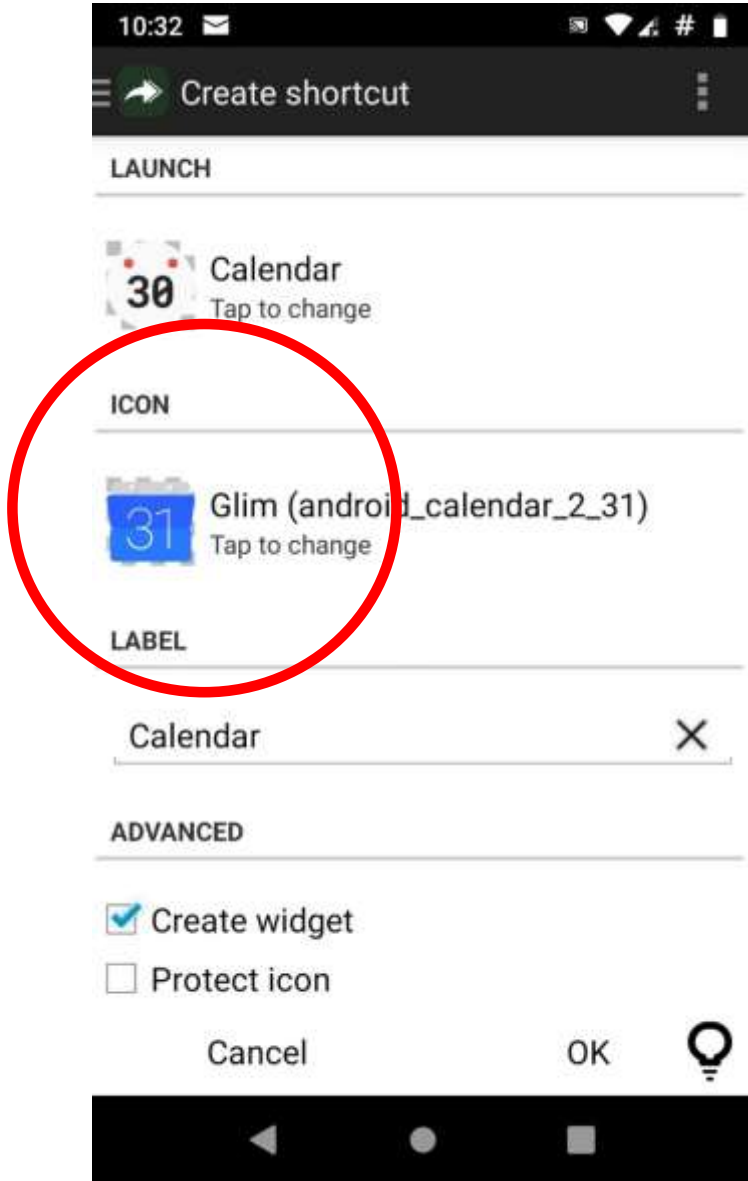

Glim has a default icon for the calendar app

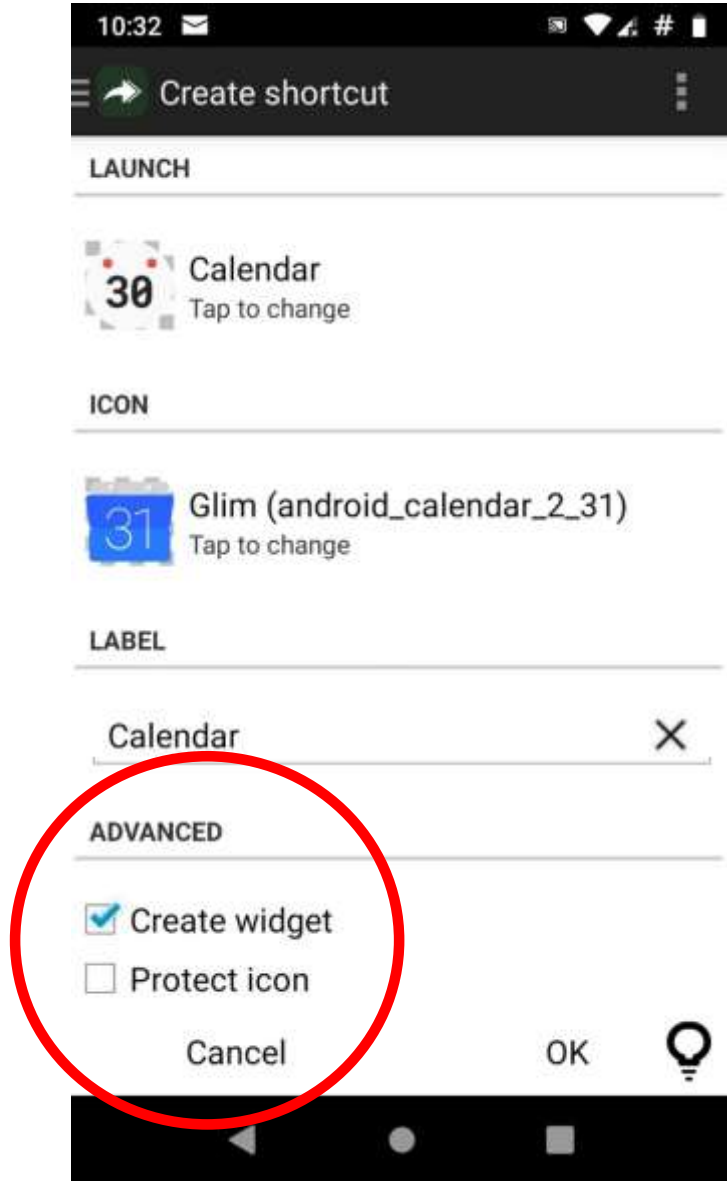

Glim has a default icon for the calendar app

Note the *Create widget* check box

Leave it checked...

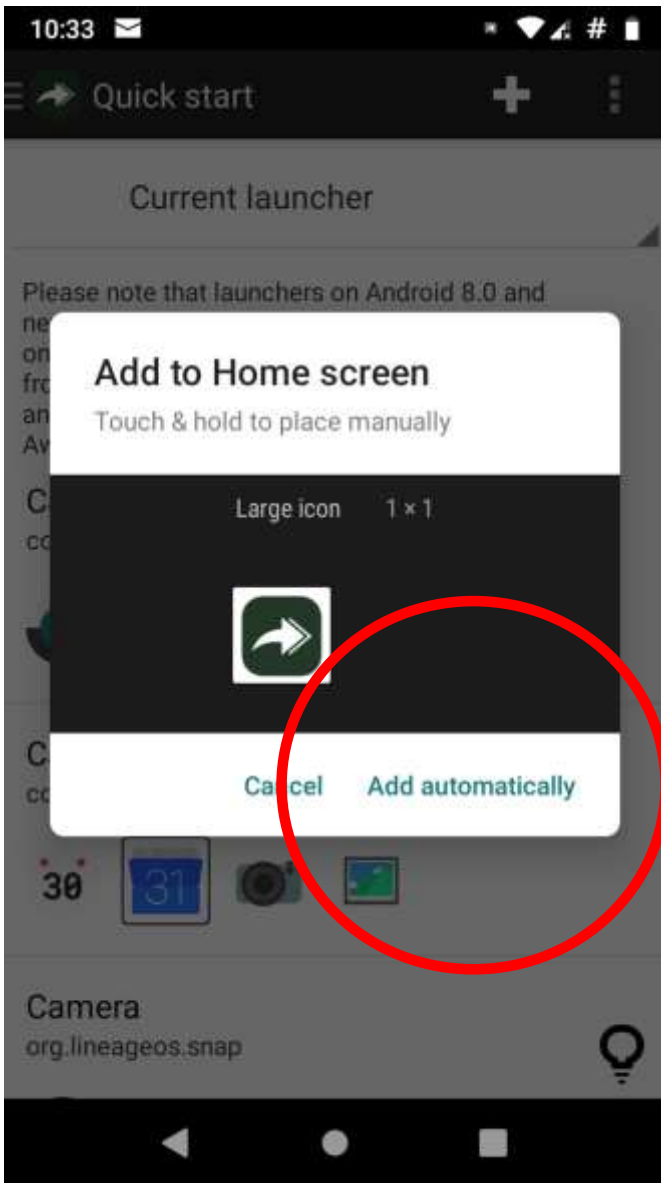

Add automatically...

...places the changed icon on the current screen

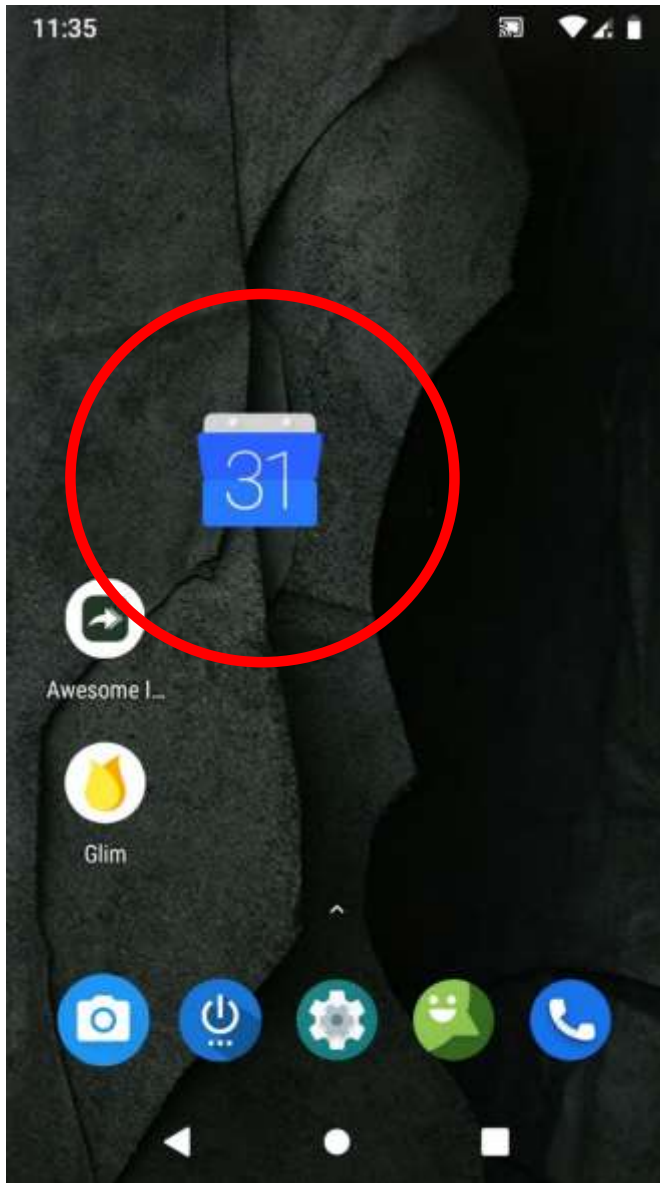

Resulting icon is large and rectangular

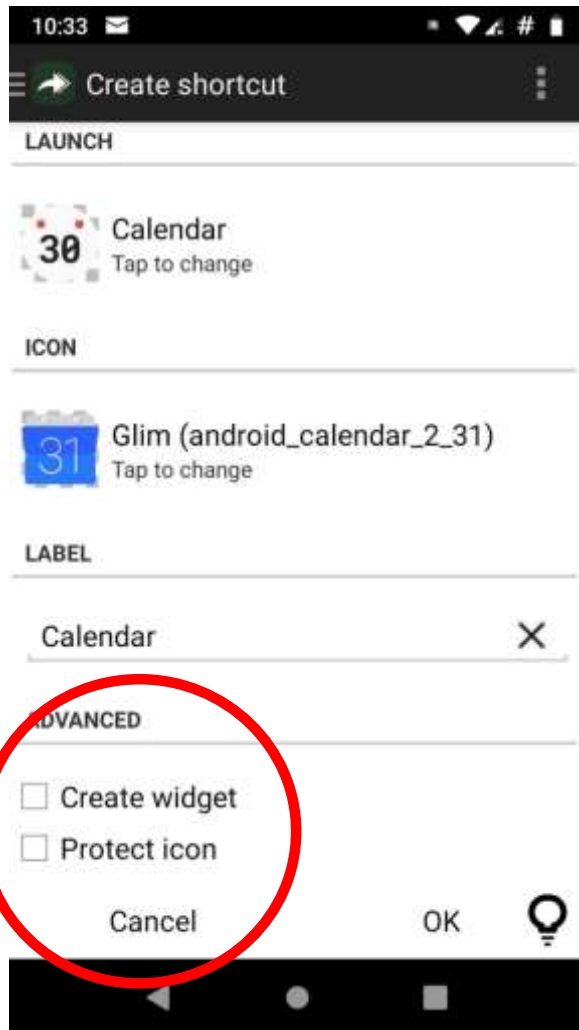

Leave *Create widget* unchecked...

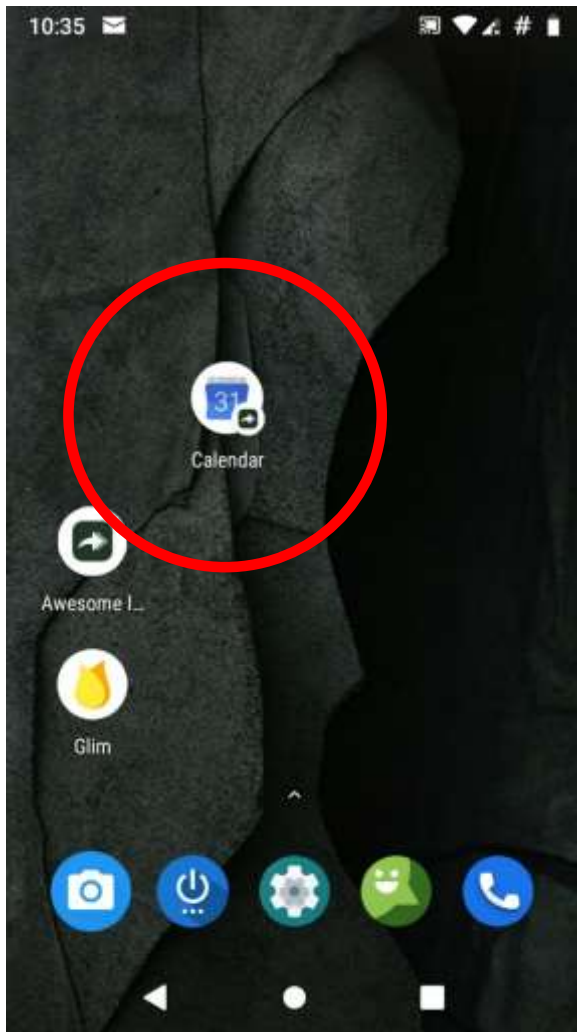

Now, we have a
small, circular icon...

BUT, there is a
shortcut arrow!

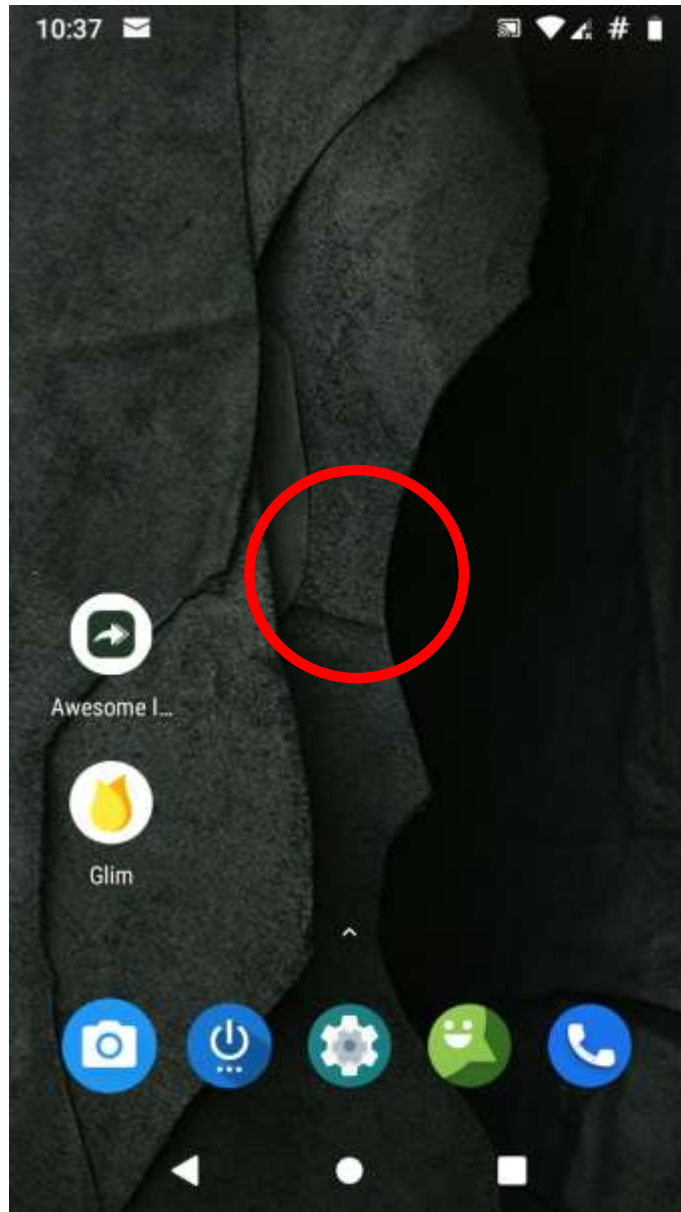

There is another method of creating an icon...

Click and hold anywhere in the blank area of the screen

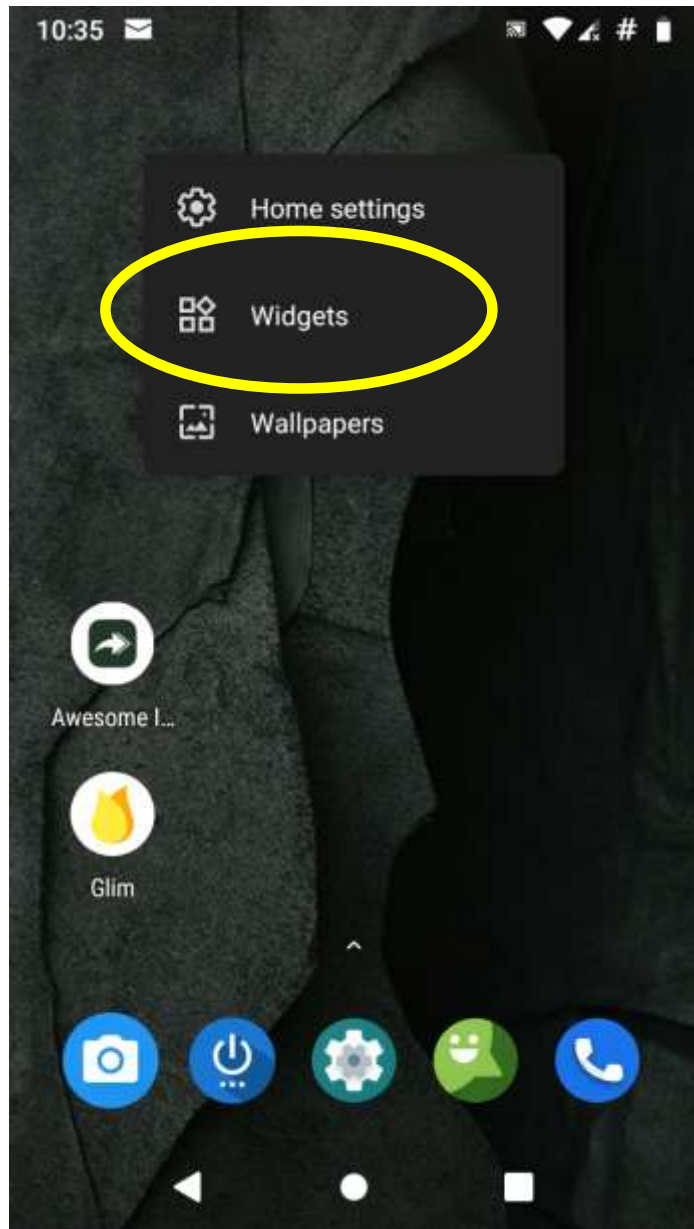

Select *Widgets*...

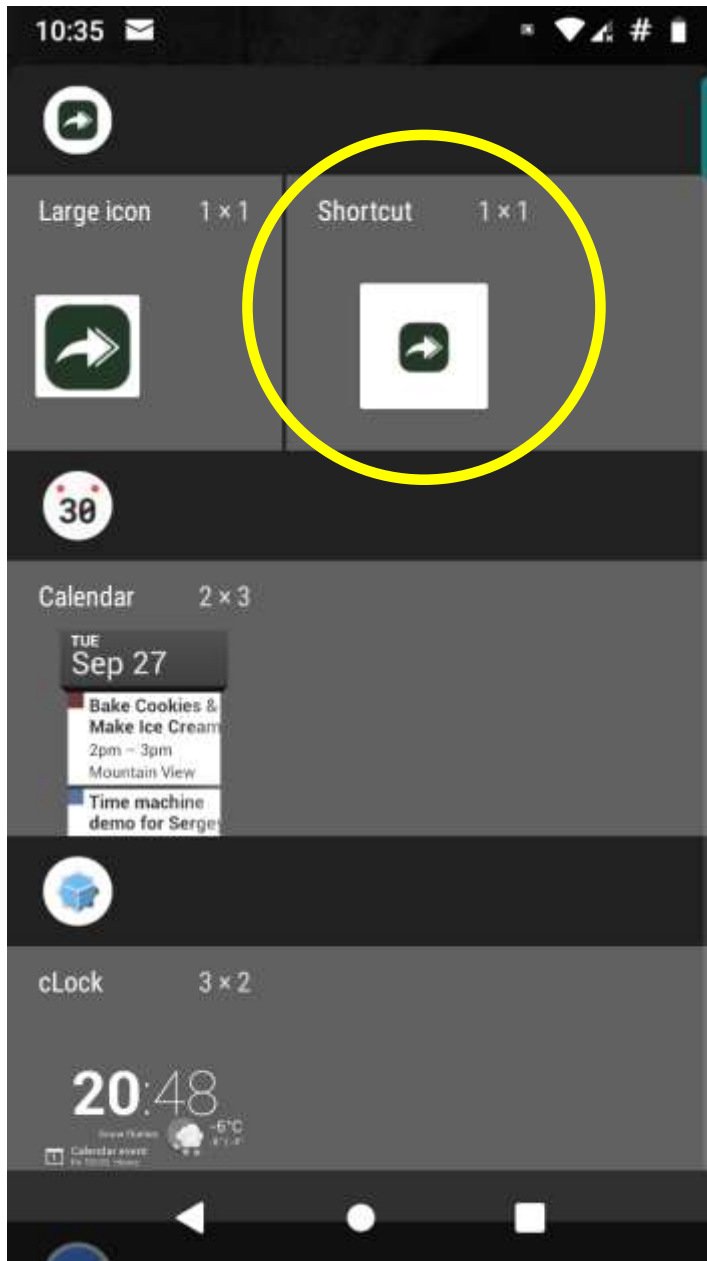

Select *Shortcut*

Drag and drop in
the blank area of
the screen

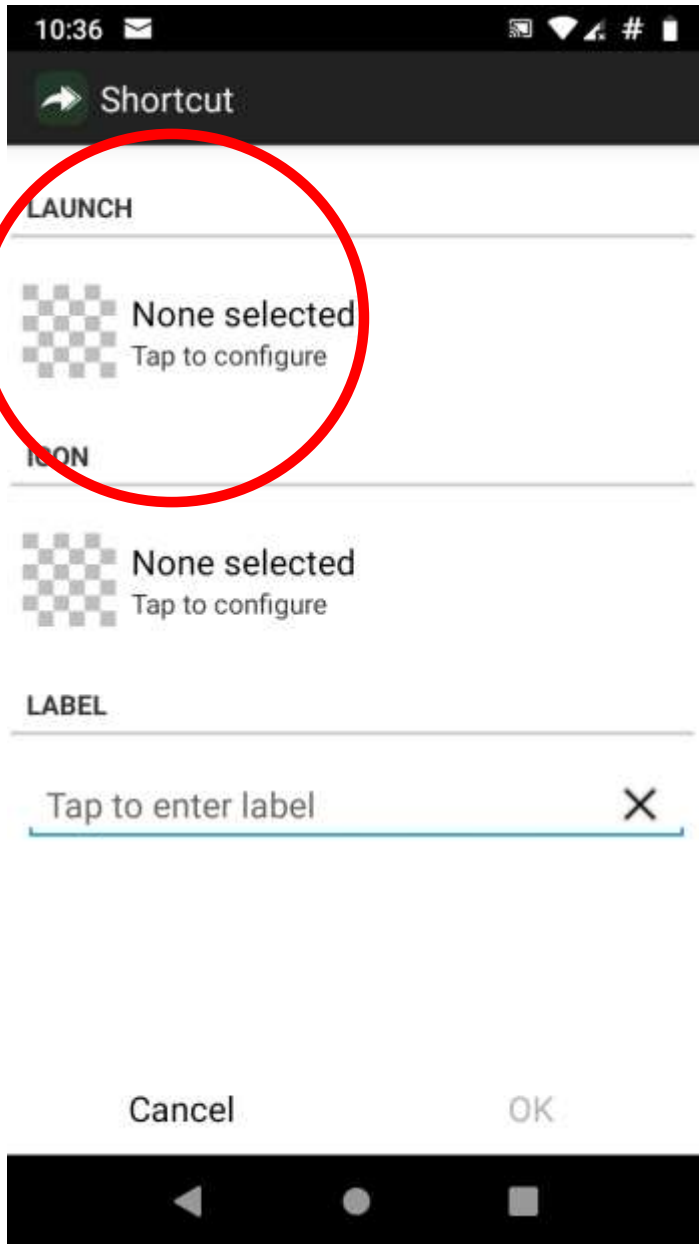

Tap the launch icon...

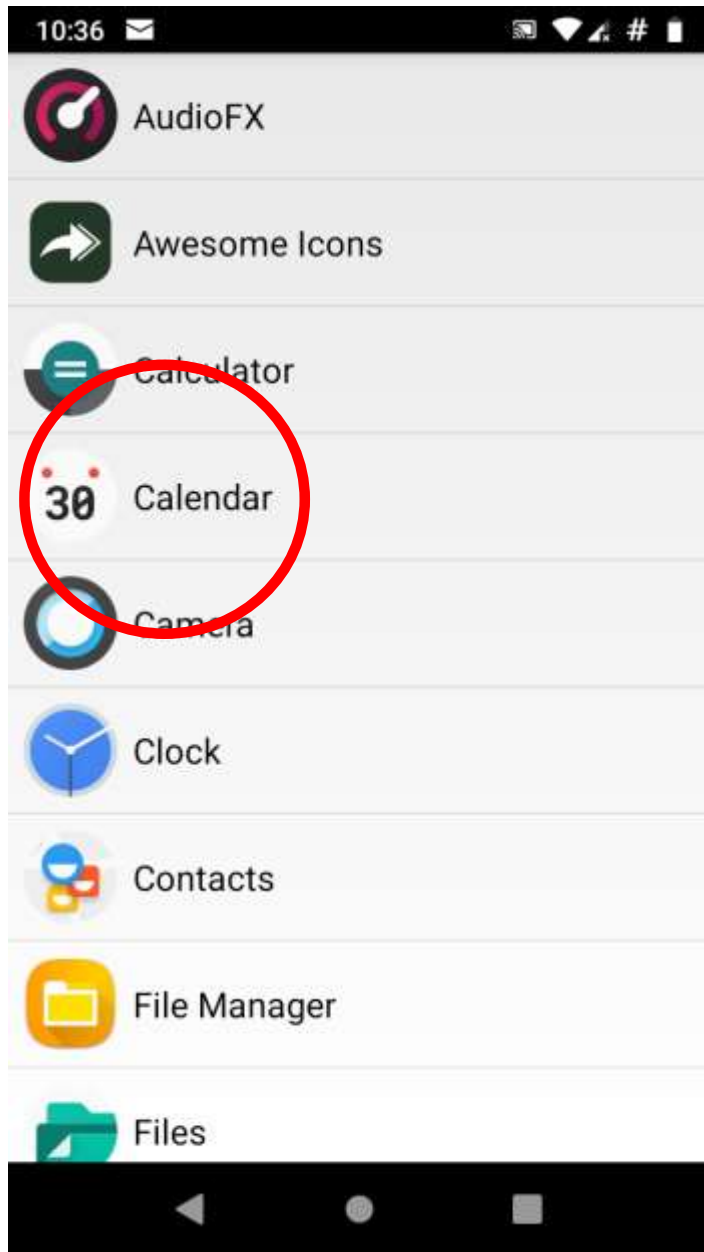

Select Calendar...

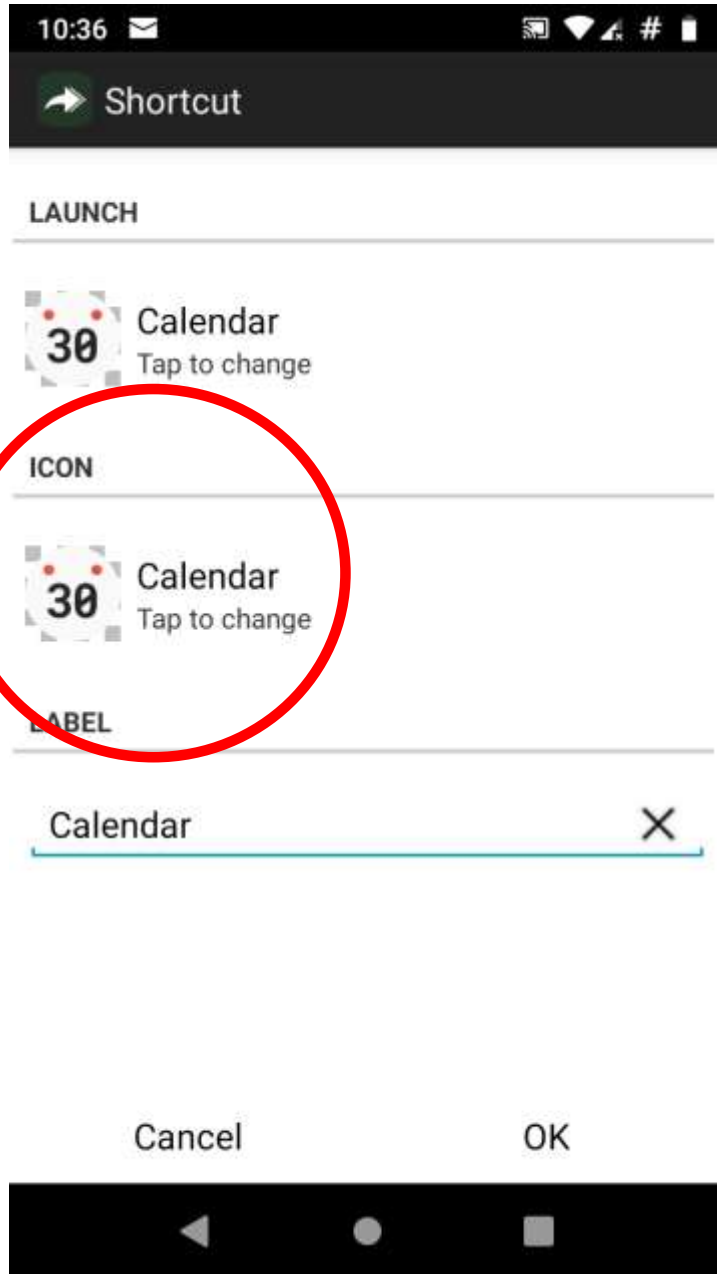

This time, we are going to select *Picture* and browse to the Google Pixel icon (calendar.png) that has been downloaded



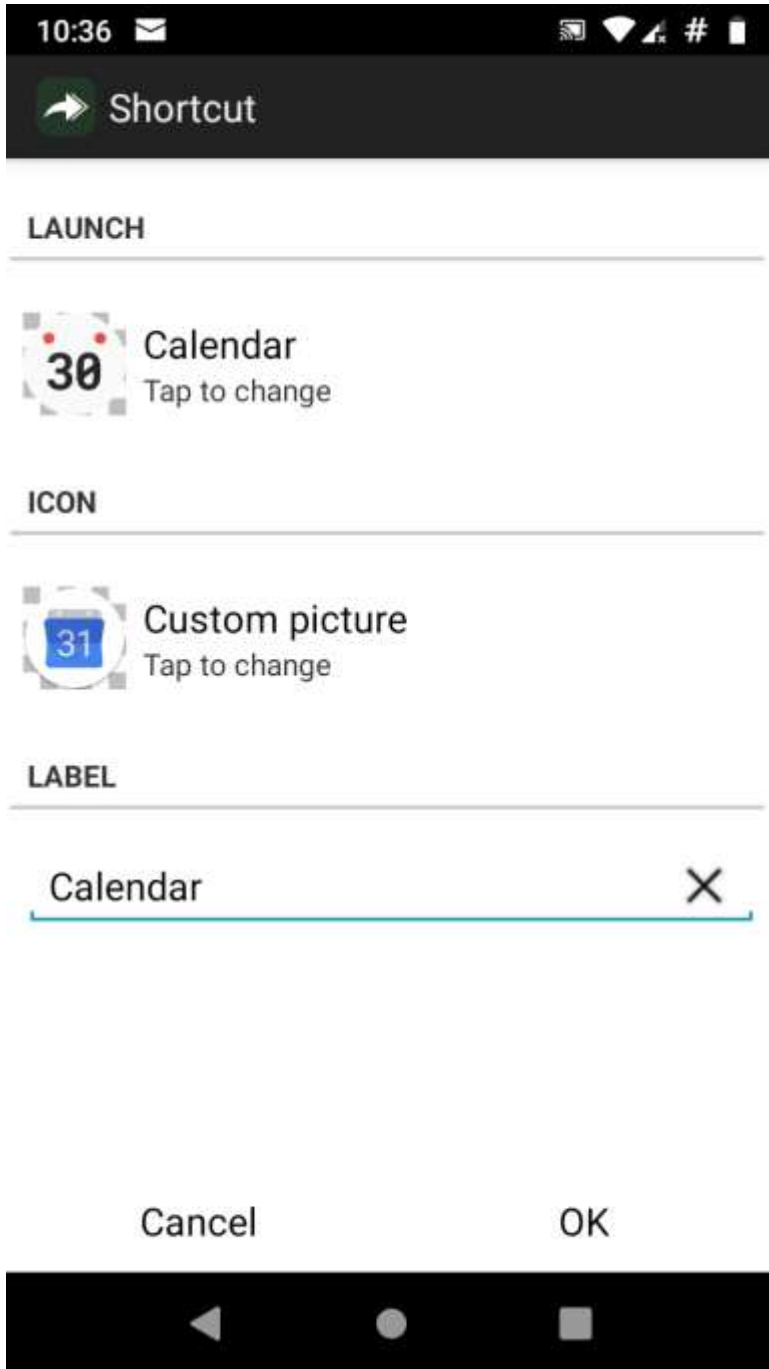

Select OK...

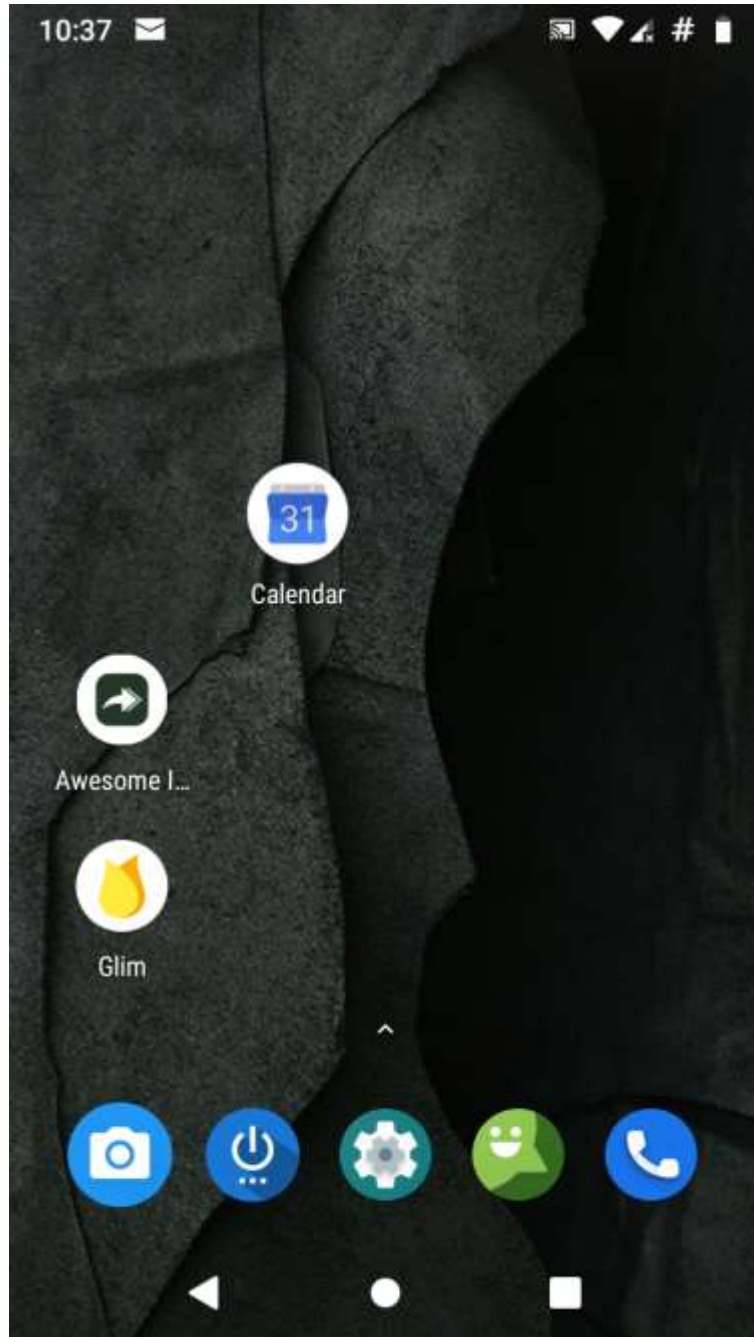

Remove the original
(ugly) icon

Drag and drop the
replacement icon onto
the home screen...

10:29



File Manager



Clock



Just Remin...



K-9 Mail



Piktures



Calendar

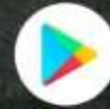

Play Store



Navigator



Fongo



Merlin



SiteFinder



Opera



WriterP



WhatsApp



Calculator



Contacts



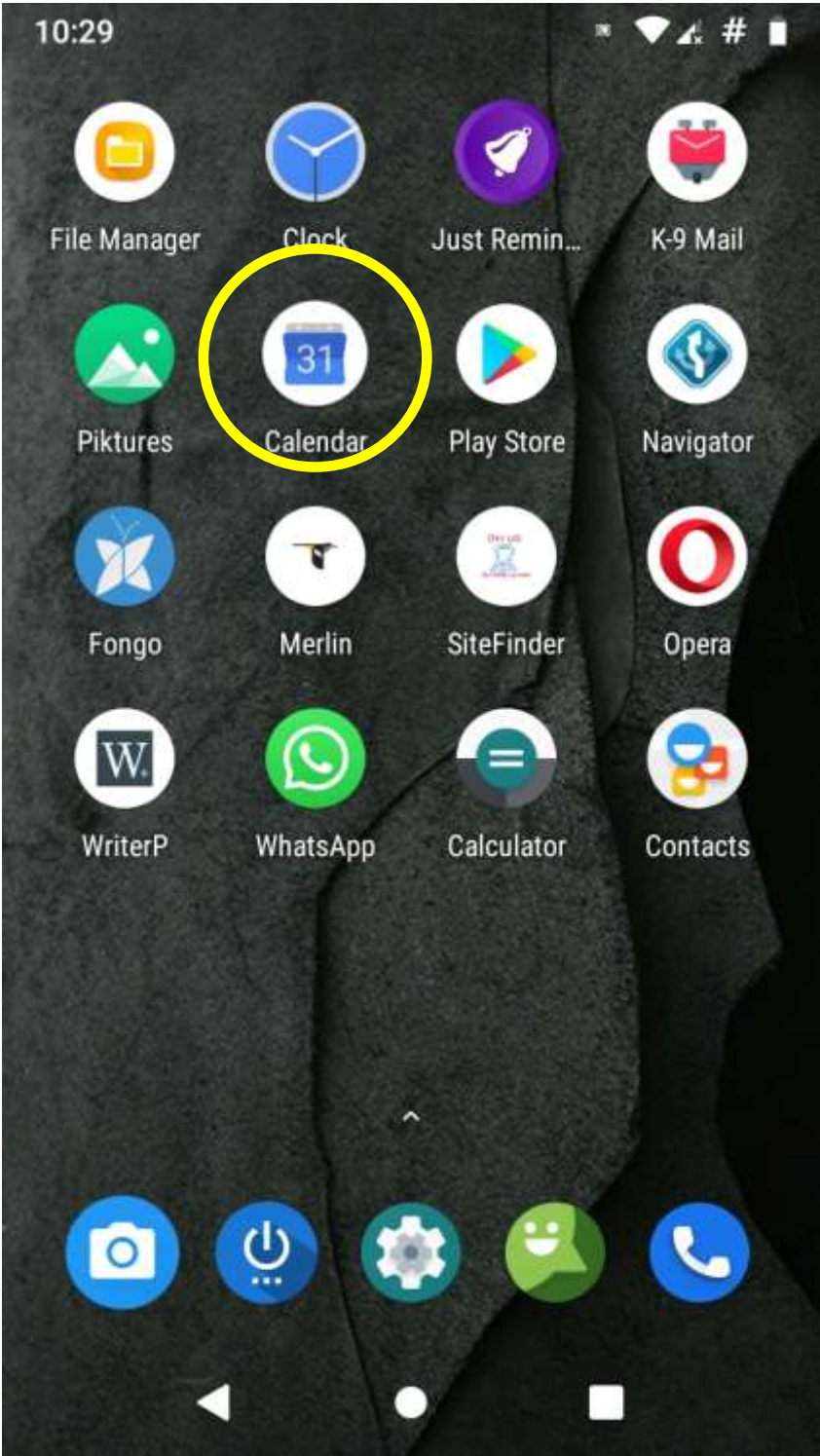



Awesome Icons

https://play.google.com/store/apps/details?id=com.momocode.shortcuts&hl=en_CA



Keeping a drive alive

- Problem: connection to a NAS (Network Attached Storage) sometimes fails
 - can take multiple attempts to access the drive
 - mostly happens when Windows first boots
 - generally stays available for rest of Windows session

A

Keeping a drive alive

- Do something to force a connection to the drive periodically
 - could click repeatedly on drive in File Manager
 - Yuck – that's so ... *manual*

A

DIR at command line

```
Command Prompt
C:\Users\CTaylor>dir z:\
Volume in drive Z is File History
Volume Serial Number is 0CBF-061F

Directory of z:\

2020-09-02  04:13 PM    <DIR>          Aludra
2019-11-14  08:20 AM    <DIR>          FileHistory
2020-11-10  09:17 AM    <DIR>          Flash-ebooks
2020-11-26  10:32 AM    <DIR>          538 KeepAlive.cmd
2020-09-16  10:14 AM    <DIR>          KeepPass
2020-11-10  09:15 AM    <DIR>          MasterClass
2020-11-14  08:01 AM    <DIR>          MVP
2020-10-22  01:59 PM    <DIR>          OldComputer
2020-04-05  08:03 AM    <DIR>          opcug.ca
2020-11-13  08:20 AM    <DIR>          Photography
2019-10-03  08:11 AM    <DIR>          TeamDrive
2020-11-25  02:34 PM    <DIR>          temp
2020-10-31  12:33 PM    <DIR>          test
2020-11-10  10:24 AM    <DIR>          Updates
2020-07-02  08:29 AM    <DIR>          Util
2020-11-26  09:53 AM    <DIR>          Work

               1 File(s)                538 bytes
              15 Dir(s)  289,519,239,168 bytes free

C:\Users\CTaylor>
```

Wake up drive Z by asking for a directory listing

Why is this not: "Yuck - that's so ... *manual*"?

Because we can script it

If we can script it, we can automate it!

A

The script

```
*KeepAlive.cmd - Notepad
File Edit Format View Help
@echo off
:KeepAlive
dir z:\ >> z:\KeepAlive.log
timeout 2
goto KeepAlive
Ln 100% Windows (CRLF) UTF-8
```

Put label at top so we can loop back to here

Do a directory listing of drive Z to wake it up

For testing, send output to a text file so we can know it's working

Pause for 2 seconds
* Short for testing
In actual operation, maybe 300 seconds

Jump back to start of script



Automate

Create Task

General | Triggers | Actions | Conditions | Settings

Name: ! Keep Alive Drive Z

Location: \

Author: CARINA\CTaylor

Description: Keeps drive Z alive by repeatedly calling for a directory listing

Security options

When running the task, use the following user account:

CARINA\CTaylor Change User or Group...

Run only when user is logged on

Run whether user is logged on or not

Do not store password. The task will only have access to local computer resources.

Run with highest privileges

Hidden

Configure for: Windows Vista™, Windows Server™ 2008

OK Cancel

Run Task Scheduler

- create a new task
- give task a name
- * I use "!" at start so it sorts to top of list

Description so you can remember why you created it years later

A

Automate what to do

Create an "action"

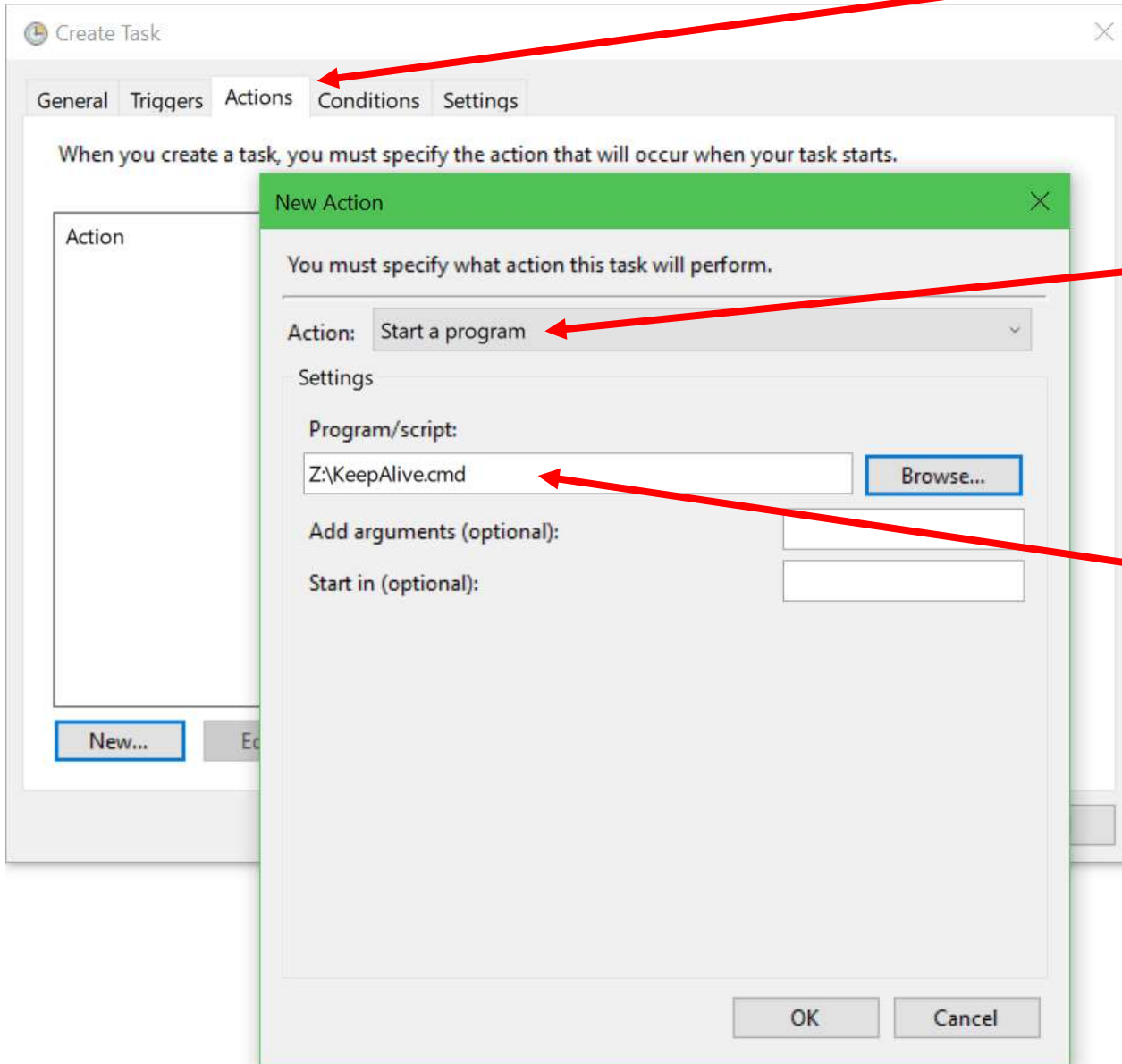

Action: Start a program

Call the script

A

Automate when to do it

Create a "trigger"

When you create a task, you can specify the conditions that will trigger the task.

Trigger

Begin the task: At log on

Settings

Any user

Specific user: CARINA\CTaylor Change User...

Advanced settings

Delay task for: 15 minutes

Repeat task every: 1 hour for a duration of: 1 day

Stop all running tasks at end of repetition duration

Stop task if it runs longer than: 1 day

Activate: 2020-11-26 10:59:04 AM Synchronize across time zones

Expire: 2021-11-26 10:59:04 AM Synchronize across time zones

Enabled

OK Cancel

"At log on"
* Don't use "At startup"
as drive might not be mapped

A

Automate

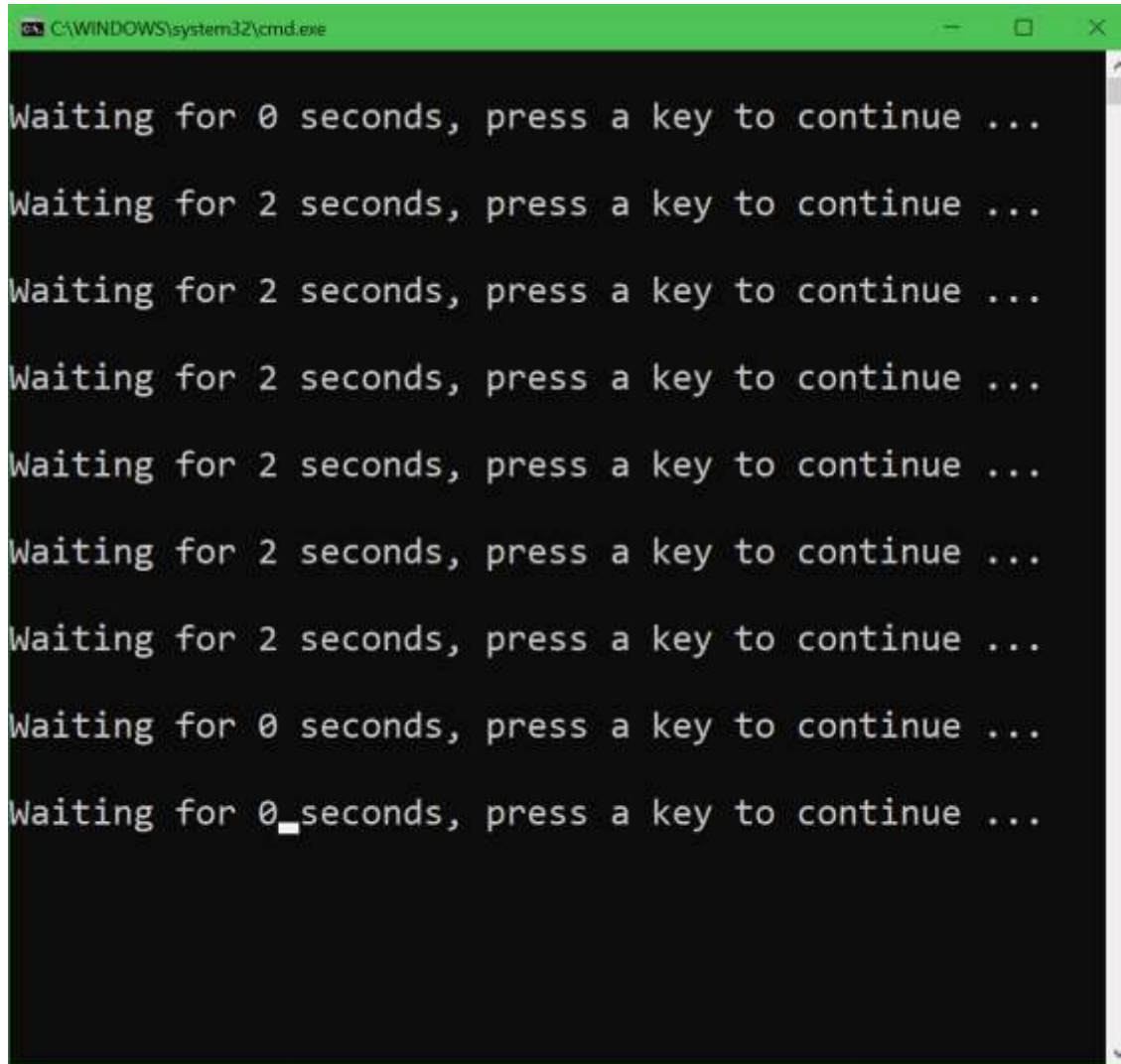

```
C:\WINDOWS\system32\cmd.exe  
Waiting for 0 seconds, press a key to continue ...  
Waiting for 2 seconds, press a key to continue ...  
Waiting for 2 seconds, press a key to continue ...  
Waiting for 2 seconds, press a key to continue ...  
Waiting for 2 seconds, press a key to continue ...  
Waiting for 2 seconds, press a key to continue ...  
Waiting for 2 seconds, press a key to continue ...  
Waiting for 0 seconds, press a key to continue ...  
Waiting for 0 seconds, press a key to continue ...
```

When it runs,
ugly box appears
could just
minimize, or...

A

Automate who to do it as

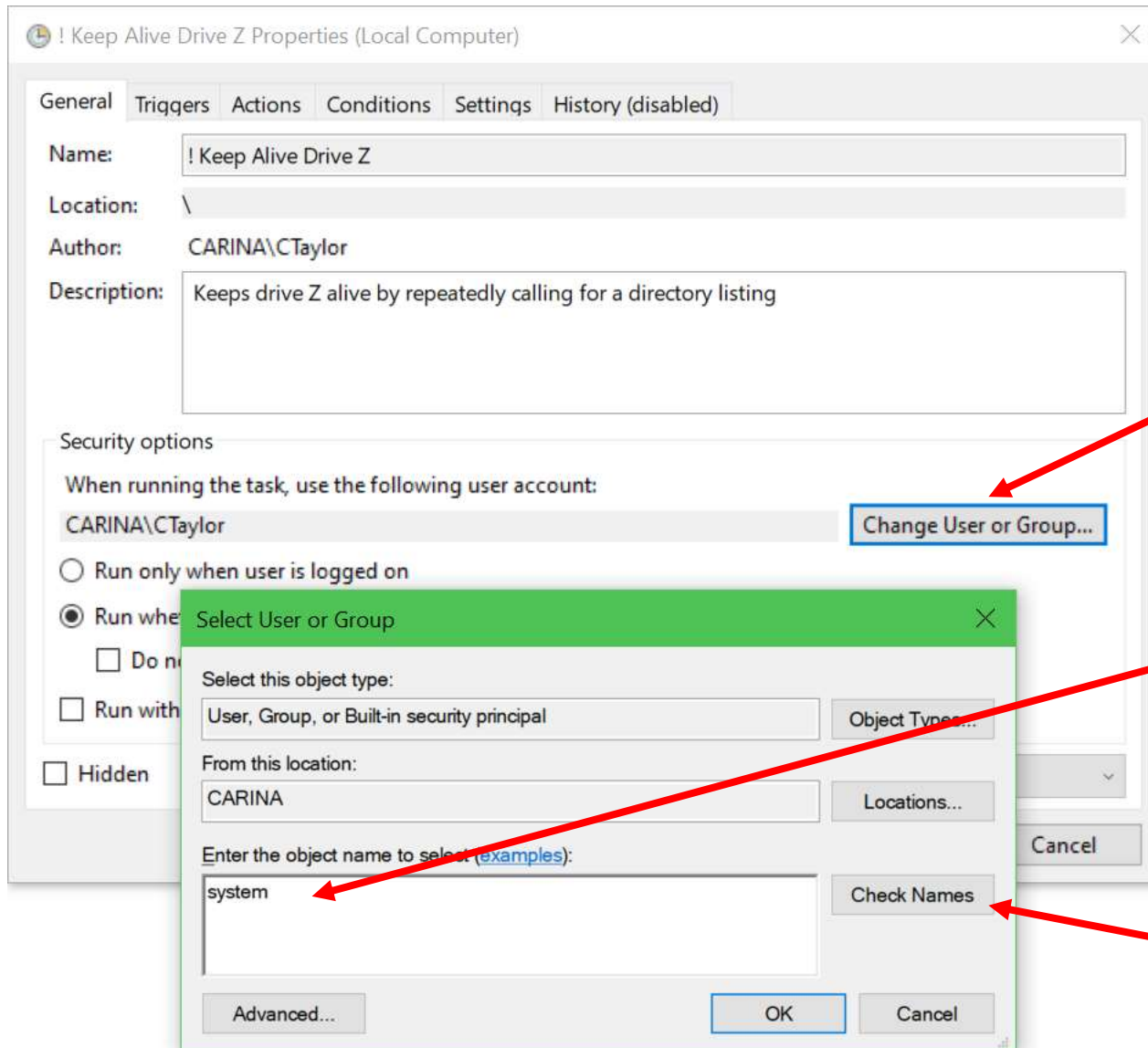

Change account used to run task

Type "system"

Click "Check Names"



MS Office Alternative?

- I'm looking for a free alternative to MS Office that can open and save to those file extensions (PDF would also be nice, but not necessary).
- Any opinions on LibreOffice, Open Office, Free Office, or any others?
- I need compatibility with both Windows 8.1 & 10.



LibreOffice

- LibreOffice can read and write Office files, and save them as PDF
- It's fairly compatible but not 100% (but likely nothing is.)
- It's free, so give it a try. If it isn't sufficient for your purposes, uninstall it and move on to another package.

- LibreOffice is a fork of OpenOffice (now Apache OpenOffice)
- Open-source package
- Major modules:
 - Writer (Word)
 - Calc (Excel)
 - Impress (PowerPoint)
 - Base (Access)



<https://www.libreoffice.org>

MS Word

LibreOffice Writer

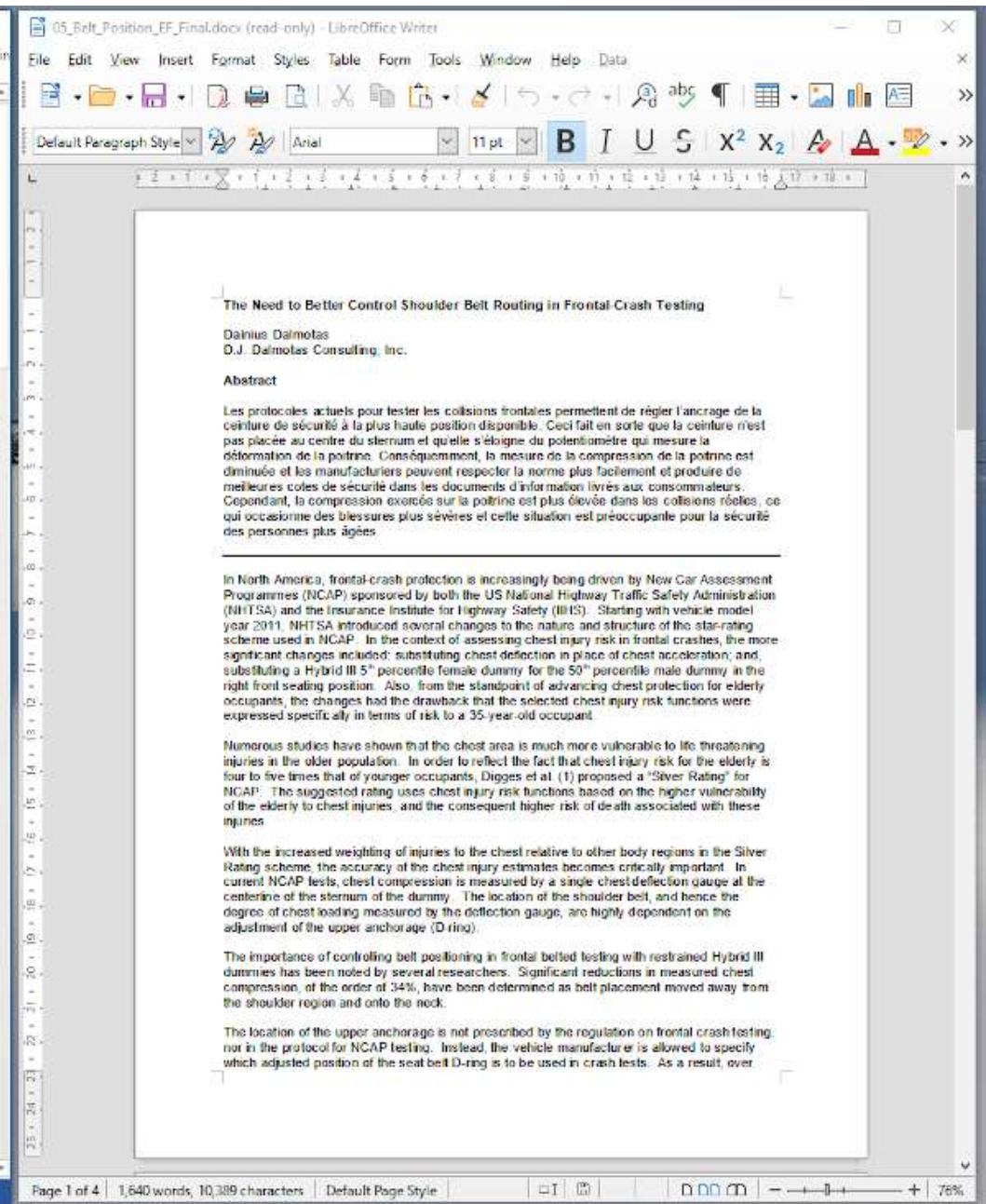
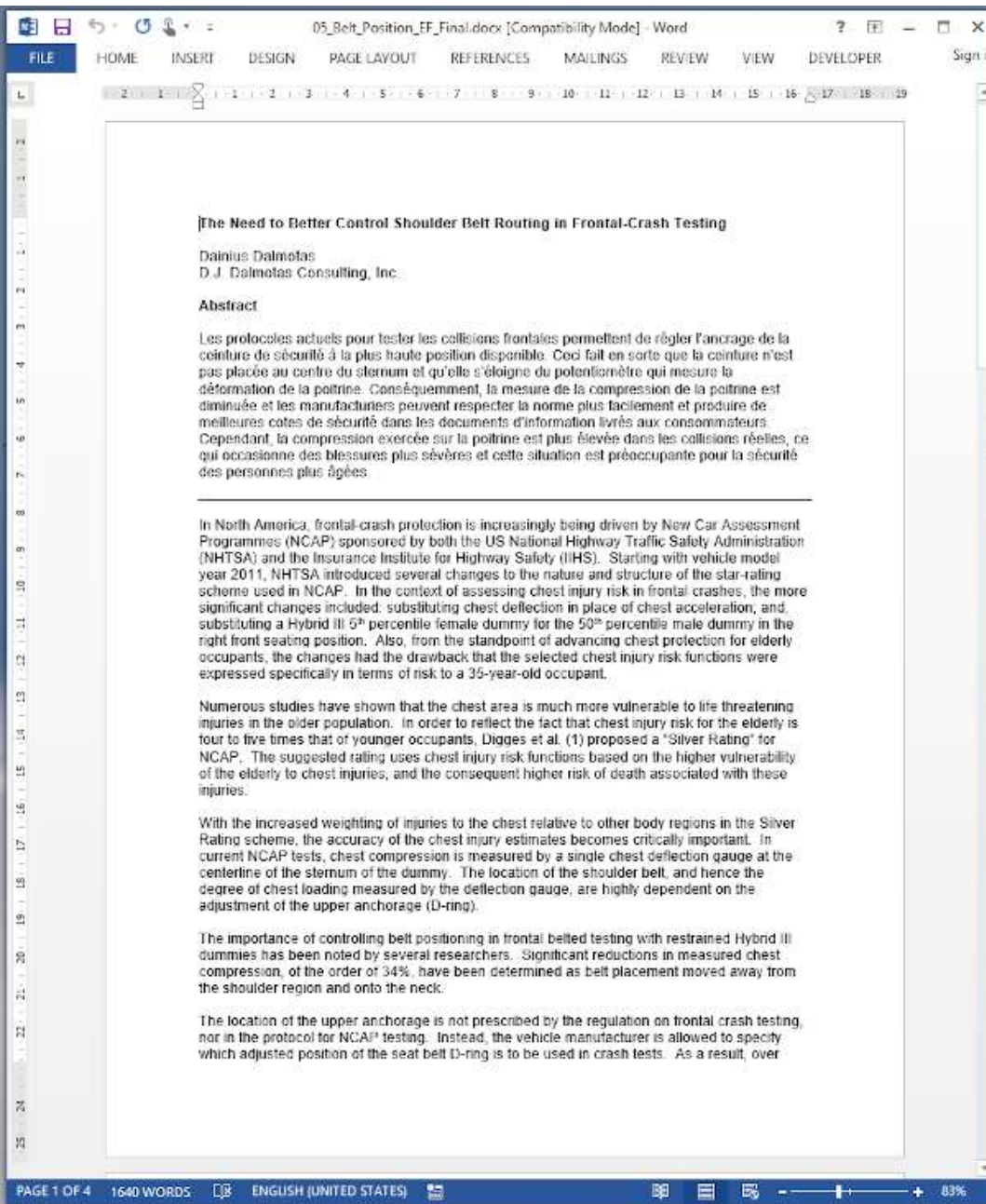

MS Word

LibreOffice Writer

OPCUG
Users helping users

Computers at War

OTTAWA – Press release date **WEDNESDAY November 4, 2020**. The Ottawa PC Users' Group (OPCUG) invites the public to participate in its upcoming **ONLINE** presentation by our own Bob Walker Wednesday Nov. 11th General Meeting.

In response to COVID-19, the OPCUG is holding a Zoom video conference event (see <https://opcug.ca/wp-content/uploads/2020/07/Zoom-instructions2.pdf> for details on how to connect to the video conference), with the meeting opening at 7:15.

In honour of the November OPCUG Meeting being on Remembrance Day, we'll look at how the development of early computers was brought about by World War Two. In particular we will be looking at the codebreakers of Bletchley Park like computer pioneers Alan Turing, Gordon Welchman, Tommy Flowers and Max Newman who developed Colossus, the world's first programmable, electronic, digital computer, and used it to break the German Enigma codes and shorten the war by two years.

We'll also look at some of the other computer developments related to the war and how some of it led directly to the development of the Internet.

Details at <https://opcug.ca/events/computers-at-war/>

We will wrap up the evening with our regular Q&A session. Bring your questions - and help out with your answers - and help fulfill our motto "users helping users"

--- 30 ---

OPCUG is a not-for-profit organization located in Ottawa, Ontario. Our motto is *Users helping users*, a task we have undertaken for more than 35 years. Every 2nd Wednesday of the month (except for July and August) we present a topic that is of interest to our membership and the public at large.

For more information:

Chris Taylor, President, chris.taylor@opcug.ca
Lawrence Patterson, Meeting Coordinator, lawrence@opcug.ca

OPCUG_Nov2020_CompAtWr_PressRelease.docx - Word

FILE HOME INSERT DESIGN PAGE LAYOUT REFERENCES MAILINGS REVIEW VIEW DEVELOPER DESIGN

1 2 3 4 5 6 7 8 9 10 11 12 13 14 15 16 17 18 19 20

PAGE 1 OF 1 339 WORDS ENGLISH (CANADA) 83%

OPCUG
Users helping users

Computers at War

OTTAWA – Press release date **WEDNESDAY November 4, 2020**. The Ottawa PC Users' Group (OPCUG) invites the public to participate in its upcoming **ONLINE** presentation by our own Bob Walker Wednesday Nov. 11th General Meeting.

In response to COVID-19, the OPCUG is holding a Zoom video conference event (see <https://opcug.ca/wp-content/uploads/2020/07/Zoom-instructions2.pdf> for details on how to connect to the video conference), with the meeting opening at 7:15.

In honour of the November OPCUG Meeting being on Remembrance Day, we'll look at how the development of early computers was brought about by World War Two. In particular we will be looking at the codebreakers of Bletchley Park like computer pioneers Alan Turing, Gordon Welchman, Tommy Flowers and Max Newman who developed Colossus, the world's first programmable, electronic, digital computer, and used it to break the German Enigma codes and shorten the war by two years.

We'll also look at some of the other computer developments related to the war and how some of it led directly to the development of the Internet.

Details at <https://opcug.ca/events/computers-at-war/>

We will wrap up the evening with our regular Q&A session. Bring your questions - and help out with your answers - and help fulfill our motto "users helping users"

--- 30 ---

OPCUG is a not-for-profit organization located in Ottawa, Ontario. Our motto is *Users helping users*, a task we have undertaken for more than 35 years. Every 2nd Wednesday of the month (except for July and August) we present a topic that is of interest to our membership and the public at large.

For more information:

Chris Taylor, President, chris.taylor@opcug.ca
Lawrence Patterson, Meeting Coordinator, lawrence@opcug.ca

OPCUG_Nov2020_CompAtWr_PressRelease.docx (read-only) - LibreOffice Writer

File Edit View Insert Format Styles Table Form Tools Window Help Data

Default Paragraph Style Calibri 11 pt B I U S X² X₂

1 2 3 4 5 6 7 8 9 10 11 12 13 14 15 16 17 18 19 20

Page 1 of 1 339 words, 2,197 characters Default Page Style Table:1A1 73%



LibreOffice Calc

D17

	A	B	C	D	E	F	G	H	I	J	K	L	M	N
1	Accounts 2020													
2														
3	Month	Balance	Memberships	Raffle	Interest	Pub II	Newsletter	Misc Exp	Cash		Income			
4		RBC		Mug/Tool		Bell	Print	Bank			Membership		20.00	
5		ING		Other		ADSL	Post						0.00	
6						Hardware							0.00	
7													0.00	
8	Jan-2020	17332.35	160.00	21.00	10.38			172.94	17350.79			Total	20.00	
9	Feb-2020	17350.79	160.00	20.25	8.37			136.53	17402.88		Coffee		0.00	
10	Mar-2020	17402.88	280.00	22.00	1.65			11.99	17694.54		Mugs		0.00	
11	Apr-2020	17694.54	60.00		1.25			60.93	17694.86		Other		0.00	
12	May-2020	17694.86			1.06			4.95	17690.97				0.00	
13	Jun-2020	17690.97	120.00		1.02			286.63	17525.36				0.00	
14	Jul-2020	17525.36			1.06			4.95	17521.47			Total	0.00	
15	Aug-2020	17521.47	80.00		1.06	50.40		5.83	17546.30		Interest		1.06	
16	Sep-2020	17546.30	80.00		1.02			107.91	17519.41				0.00	
17	Oct-2020	17519.41	20.00		1.06	21.46		5.83	17513.18				0.00	
18	Nov-2020	17513.18							17513.18			Total	1.06	
19	Dec-2020	17513.18							17513.18					
20														
21	Totals		960.00	63.25	27.93	71.86	0.00	798.49			Expenses			
22											ADSL		21.46	
23													0.00	
24				Total Income	1,051.18		Total Expense	870.35					0.00	
25							Income over expenses	180.83				Total	21.46	
26	Cash on Hand		31-Oct-20								Newsletter		0.00	
27													0.00	
28	TDCT	1,240.13											0.00	
29	ING	4,167.69										Total	0.00	
30	ING-GIC	12,000.00	16,167.69								Bank charges		4.95	
31	Petty Cash	2.80									Other		0.88	
32	PayPal	102.56											0.00	
33													0.00	
34	Total	17,513.18											0.00	
35													0.00	
36	Floats												0.00	
37	Membership	40.00											0.00	
38												Total	5.83	
39	Total	17,553.18												
40														
41														
42														

Balance is CORRECT
Income over expenses \$180.83

Amounts in Columns F-H stated as positive values in this sheet
Formulae in Column I and Income over expenses (G33) updated

FILE HOME Injury New Tab INSERT PAGE LAYOUT FORMULAS DATA REVIEW VIEW DEVELOPER

Cut Copy Paste Format Painter

Arial1 11 A A

B I U

Wrap Text

Number

Alignment

Number

Microsoft Excel

	A	B	C	D	E	F	G	H	I	J	K	L	M	N
1	Accounts 2020													
2														
3	Month	Balance	Memberships	Raffle	Interest	Pub II	Newsletter	Misc Exp	Cash		Income			
4		RBC		Mug/Tool		Bell	Print	Bank			Membership		20.00	
5		ING		Other		ADSL	Post						0.00	
6						Hardware							0.00	
7													0.00	
8	Jan-2020	17332.35	160.00	21.00	10.38			172.94	17350.79			Total	20.00	
9	Feb-2020	17350.79	160.00	20.25	8.37			136.53	17402.88		Coffee		0.00	
10	Mar-2020	17402.88	280.00	22.00	1.65			11.99	17694.54		Mugs		0.00	
11	Apr-2020	17694.54	60.00		1.25			60.93	17694.86		Other		0.00	
12	May-2020	17694.86			1.06			4.95	17690.97				0.00	
13	Jun-2020	17690.97	120.00		1.02			286.63	17525.36			Total	0.00	
14	Jul-2020	17525.36			1.06			4.95	17521.47			Total	0.00	
15	Aug-2020	17521.47	80.00		1.06	50.40		5.83	17546.30		Interest		1.06	
16	Sep-2020	17546.30	80.00		1.02			107.91	17519.41				0.00	
17	Oct-2020	17519.41	20.00		1.06	21.46		5.83	17513.18				0.00	
18	Nov-2020	17513.18							17513.18			Total	1.06	
19	Dec-2020	17513.18							17513.18					
20											Expenses			
21	Totals		960.00	63.25	27.93	71.86	0.00	798.49			ADSL		21.46	
22													0.00	
23				Total Income	1,051.18		Total Expense	870.35					0.00	
24						Income over expenses	180.83					Total	21.46	
25											Newsletter		0.00	
26	Cash on Hand		31-Oct-20										0.00	
27													0.00	
28	TDCT	1,240.13											0.00	
29	ING	4,167.69										Total	0.00	
30	ING-GIC	12,000.00	16,167.69								Bank charges		4.95	
31	Petty Cash	2.80				Balance is	CORRECT				Other		0.88	
32	PayPal	102.56											0.00	
33						Income over expenses	\$180.83						0.00	
34	Total	17,513.18											0.00	
35													0.00	
36	Floats												0.00	
37	Membership	40.00											0.00	
38						Amounts in Columns F-H stated as positive values in this sheet					Total	5.83		
39	Total	17,553.18				Formulae in Column I and Income over expenses (G33) updated								

LibreOffice Calc

15	Aug-2020	17521.47	80.00		1.06	50.40		5.83
16	Sep-2020	17546.30	80.00		1.02			107.91
17	Oct-2020	17519.41	20.00	99.00	1.06	21.46		5.83
18	Nov-2020	17612.18						
19	Dec-2020	17612.18						
20								
21	Totals		960.00	162.25	27.93	71.86	0.00	798.49
22								
23				Total Income	1,150.18		Total Expense	870.35
24							Income over expenses	279.83
25								
26	Cash on Hand		31-Oct-20					
27								
28	TDCT	1,240.13						
29	ING	4,167.69						
30	ING-GIC	12,000.00	16,167.69					
31	Petty Cash	2.80		Balance is		INCORRECT		-99.00
32	PayPal	102.56		Income over expenses		\$279.83		
33								
34	Total	17,513.18						
35								
36	Floats							

Microsoft Excel

15	Aug-2020	17521.47	80.00		1.06	50.40		5.83
16	Sep-2020	17546.30	80.00		1.02			107.91
17	Oct-2020	17519.41	20.00	99.00	1.06	21.46		5.83
18	Nov-2020	17612.18						
19	Dec-2020	17612.18						
20								
21	Totals		960.00	162.25	27.93	71.86	0.00	798.49
22								
23				Total Income	1,150.18		Total Expense	870.35
24							Income over expenses	279.83
25								
26	Cash on Hand		31-Oct-20					
27								
28	TDCT	1,240.13						
29	ING	4,167.69						
30	ING-GIC	12,000.00	16,167.69					
31	Petty Cash	2.80		Balance is		INCORRECT		-99.00
32	PayPal	102.56		Income over expenses		\$279.83		
33								
34	Total	17,513.18						
35								
36	Floats							

FILE

HOME

Injury

New Tab

INSERT

PAGE LAYOUT

FORMULAS

DATA

REVIEW

VIEW

DEVELOPER



Cut



Copy



Format Painter

Clipboard

Arial

10

A A

B I U



Font



Alignment



Wrap Text

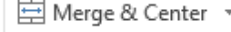

Merge & Center

General

\$ % ' .00 .00

Number

Microsoft Excel

B40



fx

A B C D E F G H I J K L M N O P Q R S



Enter case information

Selected : Case No. RR-068

Select 48 km/h test data

Selected : Test No. 99-238 (1999 Chevrolet Cavalier)

Select 40 km/h test data

Selected : Test No. 98-214 (1998 Chevrolet Cavalier)

View chart

View the acceleration chart comparing the crash pulses

Print report

Print report or export it as a PDF file

Microsoft Excel interface showing the HOME tab with options like FILE, HOME, INJURY, NEW TAB, INSERT, PAGE LAYOUT, and FONTS. The font settings are set to Arial, size 10.

Header area of the spreadsheet with columns A through G. It contains a logo and the text: "Collision Investigation and Research", "Enquêtes sur les collisions et recherche", and "EDR Crash Pulse Comparison". A green box highlights the text "Microsoft Excel".

Formula bar showing "B40" and a function icon.

Sub-header area of the spreadsheet with columns A through J. It contains a logo and the text: "Collision Investigation and Research", "Enquêtes sur les collisions et recherche", and "EDR Crash Pulse Comparison".

Enter case information

Selected : Case No.

Select 48 km/h test data

Selected : Test No.!

Select 40 km/h test data

Selected : Test No.!

View chart

View the acceleration

Print report

Print report or export

Case Vehicle's EDR compared to Crash Tests

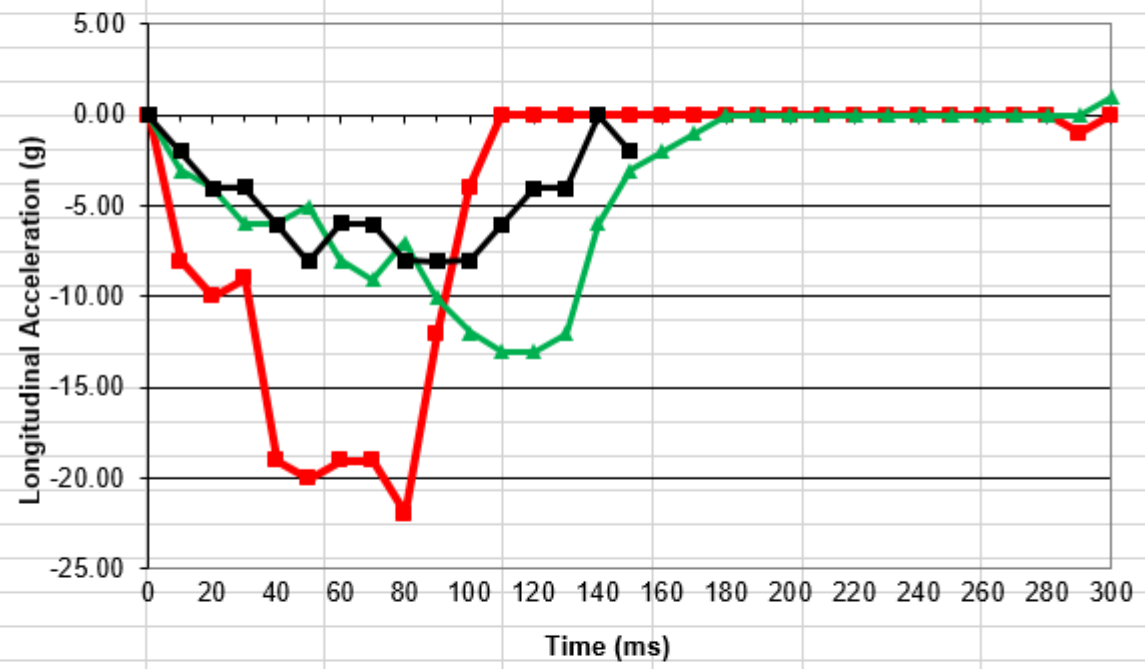

- 48 km/h FRB crash test
- ▲ 40 km/h ODB crash test
- Case Vehicle EDR

Arial 10 pt B I U A

B40 \sum =



Collision Investigation and Research
Enquêtes sur les collisions et recherche
EDR Crash Pulse Comparison



Collision Investigation and Research
Enquêtes sur les collisions et recherche
EDR Crash Pulse Comparison

Enter case information

Selected : Case

Select 48 km/h test data

Selected : Test

Select 40 km/h test data

Selected : Test

View chart

View the accelera

Print report

Print report or ex

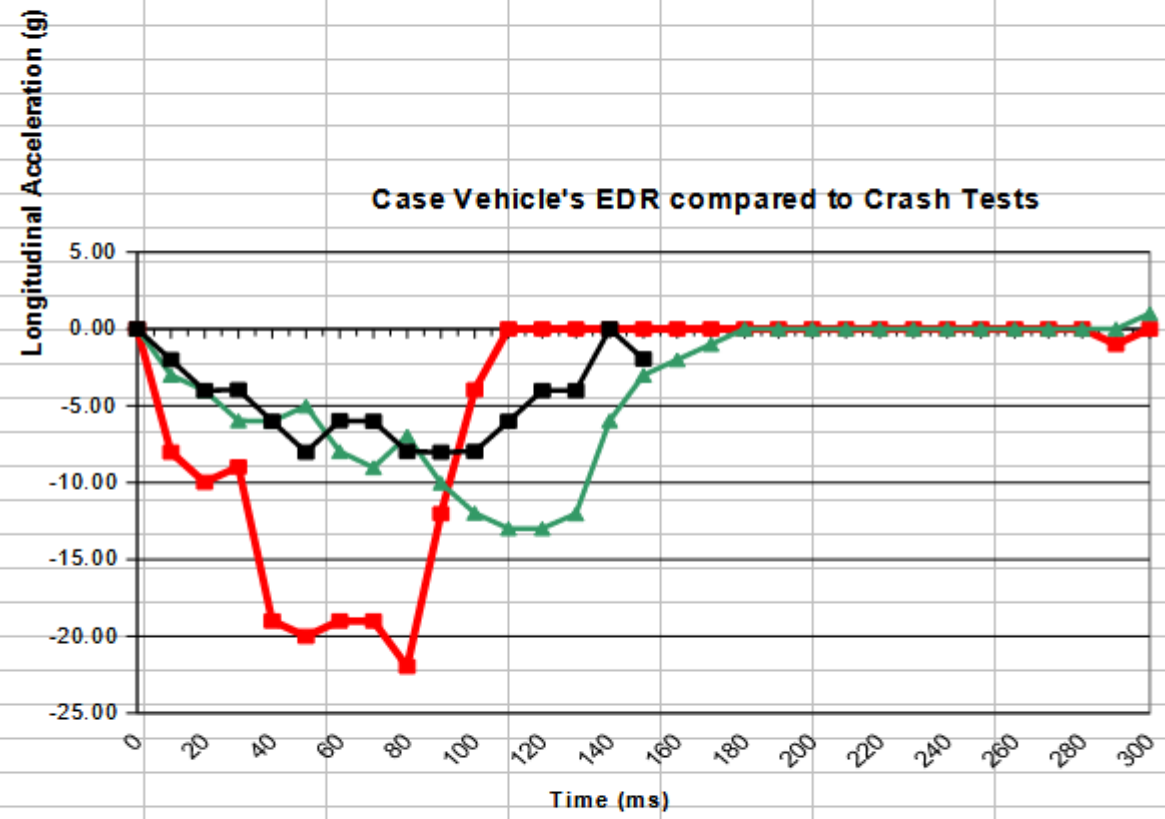

- 48 km/h FRB crash test
- ▲ 40 km/h ODB crash test

Microsoft Excel

Collision Investigation and Research
Enquêtes sur les collisions et recherche
EDR Crash Pulse Comparison

Enter case information

Select 48 km/h test data

Selected : Case I

A21:AMJ21 | fx Σ = 02-234

	A	B	C	D	E	F	G	H	I	J	K	L	M	N
1	48 km/h Rigid Barrier Crash Tests													
2	Delta-V (mph) vs. Time													
3														
4	Highlight a case number (or any cell in the row of data)										Select 48 km/h test data			
5	and press "Select 48 km/h test data"													
6														
7														
8														
9	Test No.	Year	Make	Model	t (ms)	0	10	20	30	40	50	60	70	80
11	00-118	2000	Saturn	L		-2.00	-4.00	-6.00	-8.00	-10.00	-14.00	-22.00	-24.00	
12	01-120	2001	Pontiac	Aztek		-1.47	-4.32	-7.18	-11.35	-16.39	-21.00	-26.49	-31.09	
13	01-128	2001	Chevrolet	Impala		-1.55	-3.72	-5.58	-7.44	-9.92	-13.64	-18.60	-23.56	
14	01-130	2001	Oldsmobile	Aurora		-2.04	-4.02	-6.43	-10.60	-15.21	-20.25	-24.86	-30.35	
15	01-231	2001	Saturn	L		0.00	-2.00	-4.00	-7.00	-9.00	-12.00	-16.00	-21.00	
16	02-125	2002	Chevrolet	Avalanche		-0.44	-3.07	-7.02	-10.09	-13.16	-15.80	-20.62	-24.13	
17	02-134	2002	GMC	Yukon		-0.88	-4.83	-7.90	-12.29	-16.24	-20.62	-25.89	-29.40	
18	02-213	2002	Saturn	Vue		-2.09	-4.06	-7.79	-11.52	-16.13	-20.30	-25.35	-29.95	
19	02-216	2002	GMC	Yukon		-0.88	-3.95	-7.46	-10.97	-14.92	-18.87	-24.57	-28.52	
20	02-219	2002	Chevrolet	Avalanche		0.00	-2.63	-6.58	-9.65	-13.16	-15.36	-19.75	-23.70	
21	02-234	2002	Chevrolet	Trailblazer		-2.17	-7.44	-13.02	-19.84	-24.80	-28.21	-30.07	-31.00	
22	03-120	2003	Buick	RendezVous		-1.91	-4.32	-7.61	-11.35	-16.39	-21.00	-26.49	-30.65	
23	03-122	2003	Buick	Park Avenue		-1.32	-3.51	-5.70	-8.78	-13.16	-15.36	-18.87	-22.82	
24	03-127	2003	Chevrolet	Trailblazer		-2.48	-7.44	-13.33	-19.84	-22.94	-26.66	-29.14	-29.76	
25	03-209	2003	Cadillac	CTS		-3.10	-4.03	-8.68	-10.85	-15.50	-17.67	-21.08	-25.11	
26	03-212	2003	Buick	RendezVous		-1.91	-4.76	-7.61	-11.35	-15.51	-21.00	-26.92	-31.09	
27	04-116	2004	Saturn	ION		-1.32	-3.95	-5.70	-8.34	-11.85	-16.24	-21.06	-25.01	

Microsoft Excel

Collision Investigation and Research
Enquêtes sur les collisions et recherche
EDR Crash Pulse Comparison



Enter case information

Selected : Case I

Select 48 km/h test data

Selected

A21:AMJ21 | fx Σ = 02-234

	A	B	C	D	E	F	G	H	I	J	K	L	M	N
1	48 km/h Rigid Barrier Crash Tests													
2	Delta-V (mph) vs. Time													
3														
4	Highlight a case number (or any cell in the row of data)													
5	and press "Select 48 km/h test data"													
6														
7														
8														
9	Test No.	Year	Make	Model	t (ms)	0	10	20	30	40	50	60	70	80
11	00-118	2000	Saturn	L		-2.00	-4.00	-6.00	-8.00	-10.00	-12.00	-14.00	-16.00	-18.00
12	01-120	2001	Pontiac	Aztek		-1.47	-4.32	-7.18	-11.35	-16.39	-21.00	-26.49	-31.09	
13	01-128	2001	Chevrolet	Impala		-1.55	-3.72	-5.58	-7.44	-9.92	-13.64	-18.60	-23.56	
14	01-130	2001	Oldsmobile	Aurora		-2.04	-4.02	-6.43	-10.60	-15.21	-20.25	-24.86	-30.35	
15	01-231	2001	Saturn	L		0.00	-2.00	-4.00	-7.00	-9.00	-12.00	-16.00	-21.00	
16	02-125	2002	Chevrolet	Avalanche		-0.44	-3.07	-7.02	-10.09	-13.16	-15.80	-20.62	-24.13	
17	02-134	2002	GMC	Yukon		-0.88	-4.83	-7.90	-12.29	-16.24	-20.62	-25.89	-29.40	
18	02-213	2002	Saturn	Vue		-2.09	-4.06	-7.79	-11.52	-16.13	-20.30	-25.35	-29.95	
19	02-216	2002	GMC	Yukon		-0.88	-3.95	-7.46	-10.97	-14.92	-18.87	-24.57	-28.52	
20	02-219	2002	Chevrolet	Avalanche		0.00	-2.63	-6.58	-9.65	-13.16	-15.36	-19.75	-23.70	
21	02-234	2002	Chevrolet	Trailblazer		-2.17	-7.44	-13.02	-19.84	-24.80	-28.21	-30.07	-31.00	
22	03-120	2003	Buick	RendezVous		-1.91	-4.32	-7.61	-11.35	-16.39	-21.00	-26.49	-30.65	
23	03-122	2003	Buick	Park Avenue		-1.32	-3.51	-5.70	-8.78	-13.16	-15.36	-18.87	-22.82	
24	03-127	2003	Chevrolet	Trailblazer		-2.48	-7.44	-13.33	-19.84	-22.94	-26.66	-29.14	-29.76	
25	03-209	2003	Cadillac	CTS		-3.10	-4.03	-8.68	-10.85	-15.50	-17.67	-21.08	-25.11	
26	03-212	2003	Buick	RendezVous		-1.91	-4.76	-7.61	-11.35	-15.51	-21.00	-26.92	-31.09	
27	04-116	2004	Saturn	ION		-1.32	-3.95	-5.70	-8.34	-11.85	-16.24	-21.06	-25.01	

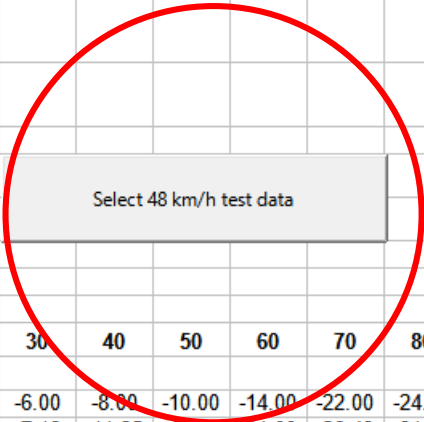

	A	B	C	D	E	F	G	H	I	J	K	L	M	N	O	P
1																
2																
3		Collision Investigation and Research														
4		Enquêtes sur les collisions et recherche														
5		EDR Crash Pulse Comparison														
6																
7																
8																
9																
10																
11		Enter case information														
12																
13																
14																
15																
16		Select 48 km/h test data														
17																
18																
19																
20																

Enter case information

Selected : Case No. RR-068

Select 48 km/h test data

Selected : Test No. 02-234 (2002 Chevrolet Trailblazer)

Collision Investigation and Research
Enquêtes sur les collisions et recherche
EDR Crash Pulse Comparison

Enter case information

Selected : Case I

Select 48 km/h test data

Select

A21:AMJ21 | f_x Σ = 02-234

	A	B	C	D	E	F	G	H	I	J	K	L	M	N
1	48 km/h Rigid Barrier Crash Tests													
2	Delta-V (mph) vs. Time													
3														
4	Highlight a case number (or any cell in the row of data)										Select 48 km/h test data			
5	and press "Select 48 km/h test data"													
6														
7														
8														
9	Test No.	Year	Make	Model	t (ms)	0	10	20	30	40	50	60	70	80
11	00-118	2000	Saturn	L		-2.00	-4.00	-6.00	-8.00	-10.00	-14.00	-22.00	-24.00	
12	01-120	2001	Pontiac	Aztek		-1.47	-4.32	-7.18	-11.35	-16.39	-21.00	-26.49	-31.09	
13	01-128	2001	Chevrolet	Impala		-1.55	-3.72	-5.58	-7.44	-9.92	-13.64	-18.60	-23.56	
14	01-130	2001	Oldsmobile	Aurora		-2.04	-4.02	-6.43	-10.60	-15.21	-20.25	-24.86	-30.35	
15	01-231	2001	Saturn	L		0.00	-2.00	-4.00	-7.00	-9.00	-12.00	-16.00	-21.00	
16	02-125	2002	Chevrolet	Avalanche		-0.44	-3.07	-7.02	-10.09	-13.16	-15.80	-20.62	-24.13	
17	02-134	2002	GMC	Yukon		-0.88	-4.83	-7.90	-12.29	-16.24	-20.62	-25.89	-29.40	
18	02-213	2002	Saturn	Vue		-2.09	-4.06	-7.79	-11.52	-16.13	-20.30	-25.35	-29.95	
19	02-216	2002	GMC	Yukon		-0.88	-3.95	-7.46	-10.97	-14.92	-18.87	-24.57	-28.52	
20	02-219	2002	Chevrolet	Avalanche		0.00	-2.63	-6.58	-9.65	-13.16	-15.36	-19.75	-23.70	
21	02-234	2002	Chevrolet	Trailblazer		-2.17	-7.44	-13.02	-19.84	-24.80	-28.21	-30.07	-31.00	
22	03-120	2003	Buick	RendezVous		-1.91	-4.32	-7.61	-11.35	-16.39	-21.00	-26.49	-30.65	
23	03-122	2003	Buick	Park Avenue		-1.32	-3.51	-5.70	-8.78	-13.16	-15.36	-18.87	-22.82	
24	03-127	2003	Chevrolet	Trailblazer		-2.48	-7.44	-13.33	-19.84	-22.94	-26.66	-29.14	-29.76	
25	03-209	2003	Cadillac	CTS		-3.10	-4.03	-8.68	-10.85	-15.50	-17.67	-21.08	-25.11	
26	03-212	2003	Buick	RendezVous		-1.91	-4.76	-7.61	-11.35	-15.51	-21.00	-26.92	-31.09	
27	04-116	2004	Saturn	ION		-1.32	-3.95	-5.70	-8.34	-11.85	-16.24	-21.06	-25.01	



Collision Investigation and Research
Enquêtes sur les collisions et recherche
EDR Crash Pulse Comparison

Enter case information

Selected : Case I

Select 48 km/h test data

Select

A21:AMJ21 | f_x Σ = 02-234

	A	B	C	D	E	F	G	H	I	J	K	L	M	N
1	48 km/h Rigid Barrier Crash Tests													
2	Delta-V (mph) vs. Time													
3														
4	Highlight a case number (or any cell in the row of data)													
5	and press "Select 48 km/h test data"													
6														
7														
8														
9	Test No.	Year	Make	Model	t (ms)	0	10	20	30	40	50	60	70	80
11	00-118	2000	Saturn	L		-2.00	-4.00	-6.00	-8.00	-10.00	-14.00	-22.00	-24.00	
12	01-120	2001	Pontiac	Aztek		-1.47	-4.32	-7.18	-11.35	-16.39	-21.00	-26.49	-31.09	
13	01-128	2001	Chevrolet	Impala		-1.55	-3.72	-5.58	-7.44	-9.92	-13.64	-18.60	-23.56	
14	01-130	2001	Oldsmobile	Aurora		-2.04	-4.02	-6.43	-10.60	-15.21	-20.25	-24.86	-30.35	
15	01-231	2001	Saturn	L		0.00	-2.00	-4.00	-7.00	-9.00	-12.00	-16.00	-21.00	
16	02-125	2002	Chevrolet	Avalanche		-0.44	-3.07	-7.02	-10.09	-13.16	-15.80	-20.62	-24.13	
17	02-134	2002	GMC	Yukon		-0.88	-4.83	-7.90	-12.29	-16.24	-20.62	-25.89	-29.40	
18	02-213	2002	Saturn	Vue		-2.09	-4.06	-7.79	-11.52	-16.13	-20.30	-25.35	-29.95	
19	02-216	2002	GMC	Yukon		-0.88	-3.95	-7.46	-10.97	-14.92	-18.87	-24.57	-28.52	
20	02-219	2002	Chevrolet	Avalanche		0.00	-2.63	-6.58	-9.65	-13.16	-15.36	-19.75	-23.70	
21	02-234	2002	Chevrolet	Trailblazer		-2.17	-7.44	-13.02	-19.84	-24.80	-28.21	-30.07	-31.00	
22	03-120	2003	Buick	RendezVous		-1.91	-4.32	-7.61	-11.35	-16.39	-21.00	-26.49	-30.65	
23	03-122	2003	Buick	Park Avenue		-1.32	-3.51	-5.70	-8.78	-13.16	-15.36	-18.87	-22.82	
24	03-127	2003	Chevrolet	Trailblazer		-2.48	-7.44	-13.33	-19.84	-22.94	-26.66	-29.14	-29.76	
25	03-209	2003	Cadillac	CTS		-3.10	-4.03	-8.68	-10.85	-15.50	-17.67	-21.08	-25.11	
26	03-212	2003	Buick	RendezVous		-1.91	-4.76	-7.61	-11.35	-15.51	-21.00	-26.92	-31.09	
27	04-116	2004	Saturn	ION		-1.32	-3.95	-5.70	-8.34	-11.85	-16.24	-21.06	-25.01	

LibreOffice Calc

EDR_compare_AG.xls - LibreOffice Calc

File Edit View Insert Format Styles Sheet Data Tools Window Help



Arial 12 pt B I U

fx Σ =

A B C D E F

1
2
3
4
5
6
7
8
9
10
11
12
13
14
15
16
17
18
19
20
21
22
23
24
25
26
27
28
29
30
31
32
33

Collision Investigation and Report
Enquêtes sur les collisions et
EDR Crash Pulse C

Enter case information

Select 48 km/h test data

Select 40 km/h test data

View chart

Print report

EDR_compare_AG.xls.VBAProject - LibreOffice Basic

File Edit View Run Dialog Tools Window Help Data



EDR_compare_AG.xls.VBAProject

Object Catalog

- My Macros & Dialogs
 - RemoveDuplicates
 - Standard
- LibreOffice Macros & Dialogs
- EDR_compare_AG.xls
 - Standard
 - VBAProject
 - Document Objects
 - Forms
 - Modules
 - Class Modules

63
64
65
66
67
68
69
70
71
72
73
74
75
76
77
78
79
80
81
82
83
84
85
86
87
88
89
90
91
92
93

```
' transposing the row values into the delta-V column  
63  
64  
65 Range("B21").Select  
66 Selection.PasteSpecial Paste:=xlPasteAll, Operation:=xlNone, SkipBlanks:= _  
67     False, Transpose:=True  
68  
69 ' Paste the test number and vehicle into the case information sheet  
70  
71 Sheets("Case vehicle information").Select  
72 Range("E31").Select  
73 ActiveCell.FormulaR1C1 = test_number  
74 Range("E33").Select  
75 ActiveCell.FormulaR1C1 = veh_year_string + " " + veh_make + " " + veh_model  
76  
77 ' Go  
78  
79 Sheet  
80 Range  
81 Activ  
82 Range  
83 Activ  
84  
85 ' For  
86  
87 Range  
88 With  
89     .Name = Arial  
90     .Size = 12  
91     .Bold = True  
92     .Strikethrough = False  
93     .Superscript = False
```

Error

BASIC runtime error.
'1'

Type: com.sun.star.lang.WrappedTargetException
Message: non-RuntimeException occurred when accessing an interface type attribute

OK

Watch:

Variable	Value	Type

Calls:

```
' Format the selection confirmation in green
```

```
Range("G17:I17").Select  
With Selection.Font  
    .Name = "Arial"  
    .Size = 12  
    .Bold = True  
    .Strikethrough = False  
    .Superscript = False  
    .Subscript = False  
    .OutlineFont = False  
    .Shadow = False  
    .Underline = xlUnderlineStyleNone  
    .Color = -11489280  
    .TintAndShade = 0  
    .ThemeFont = xlThemeFontNone  
End With
```

Q&A.pptx - PowerPoint

FILE HOME INSERT DESIGN TRANSITIONS ANIMATIONS SLIDE SHOW REVIEW VIEW

37

38



39

40

41

Click to add notes

SLIDE 40 OF 41 ENGLISH (CANADA) NOTES COMMENTS 90%



**Send your questions,
answers, and topics
you wish to share to:**

SuggestionBox@opcug.ca

The screenshot shows the LibreOffice Impress interface. The main slide features a 3D white character pointing at a large red question mark. To the right, a yellow sticky note with a red pushpin contains the text: "Don't forget: Next Q&A Dec 9th". The central text on the slide reads: "Send your questions, answers, and topics you wish to share to: SuggestionBox@opcug.ca". The left sidebar shows a slide navigation pane with thumbnails for slides 36, 37, 38, and 39. Slide 39 is the current slide, showing a smaller version of the 3D character, question mark, and sticky note. The status bar at the bottom indicates "Slide 39 of 40", "Big text box (no bullets)", "3.22 / 0.00", "0.00 x 0.00", "English (Canada)", and "100%".

Pictures

- **Pictures is a “link”***
- **It’s a pointer to a disk folder**
- **It points to:**

C:\Users\<<username>\Pictures

** Variously described as:
a system folder, special folder or shell folder,
a symbolic link or soft link
In any case, it’s a horribly complicated entry
in the Windows registry!*

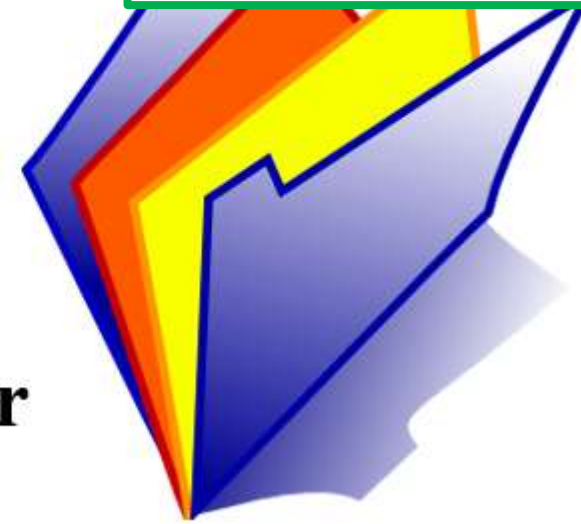

Pictures

- **Pictures is a “link”***
- **It’s a pointer to a disk folder**
- **It points to:**
C:\Users\<<username>\Pictures

** Variousy described as:
a system folder, special folder or
shell folder,
a symbolic link or soft link
In any case, it’s a horribly complicated
entry
in the Windows registry!*



MS Office Alternative?

Which free
Office Suite
would you
suggest?



From Katie T. Carpenter <termination@heavenlygem.com> ☆

Subject **Agreement data**

10:54 AM

Reply to Katie T. Carpenter <invoice> ☆

To Me <alan@alanandcarol.ca> ☆

Good Afternoon.

Your payment was successfully received. All documentation required for delivery are attached to this message.

> 1 attachment: doc5882.xls 33.5 KB

Save





“Bell” payment declined

- Can you be attacked (virus, malware, etc.) just by the process of opening an E-mail to read the text, even though you do not click on any links or open any file attached to the message?
- Sometimes one gets tricked into opening an authentic-looking spam E-mail.
- Is there a browser or E-mail setting available to prevent this type of attack?

A No...

- Theoretically, it is possible for bad things to happen just by opening an E-mail message.
- This used to be (years ago) a way of compromising computers. But, E-mail programs long ago shut off the means of exploiting computers through simply opening a message.

A No, but!

- As a general rule, it is only by clicking links within the message or opening file attachments that your computer could be compromised.
- But, with computer security, there is no such thing as 100% secure.

"The only truly secure computer is encased in concrete and dropped in the middle of the ocean. And even then, I am not 100% sure."

Share

How safe is your digital doorbell?

- Sophos
 - <https://nakedsecurity.sophos.com/2020/11/26/bzzzzzzt-how-safe-is-that-keenly-priced-digital-doorbell/>
 - a lot can go wrong with internet-enabled doorbells
 - reducing both your physical and online security at the same time
- Which?
 - <https://www.which.co.uk/news/2020/11/the-smart-video-doorbells-letting-hackers-into-your-home/>
 - 11 doorbells tested
 - All 11 demonstrated high-risk security issues
 - uploaded local Wi-Fi password to vendor's server in China unencrypted
 - device could be forced into 'setup' mode from outside your house



How do I use Messenger.com?

- Do text messages go to a phone or to a Facebook account?
- Can I select which device/account is to be used?
- How do I check if a message has been received?

Hang out
anytime,
anywhere

Messenger powers conversations within Facebook, Instagram, Portal, and Oculus.



**Any other:
Questions
Comments
Shares?**



Tech Café, OPL

Keeping Passwords Safe



Chris Taylor

Monday, December 7, 10:00 am

Register at: opcug.ca/opl-presentations/

December Meeting



09 DECEMBER
Teleconference

WEDNESDAY

WiFi Offerings & What to
Watch Out For



Lawrence Patterson

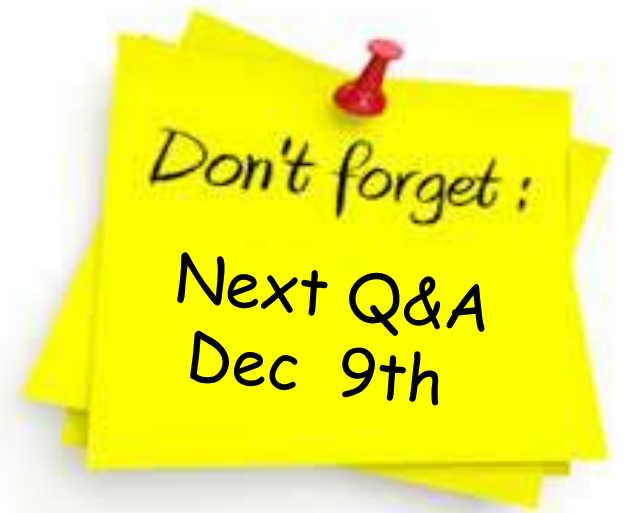

**Send your questions,
answers, and topics
you wish to share to:**

SuggestionBox@opcug.ca

